

Documentatie Persslangkoppelingen



Fanatiek in Hydrauliek

De gegevens in deze documentatie zijn met de grootste zorg samengesteld, maar mogen geen reden zijn om ons aansprakelijk te stellen voor de gevolgen van fouten, die ondanks alle controles toch nog zouden kunnen zijn achtergebleven.

Wij behouden ons het recht voor aanvullingen of wijzigingen aan te brengen zonder voorafgaande mededeling te doen.

Uiteraard zijn wij niet beperkt tot dit assortiment, specials kunt u altijd bij ons aanvragen!

versie 1.5

Technische gegevens

Aanwijzingen voor vaststellen van aansluitingen.

d = in de wartel of binnendraad gemeten D = op de uitw. draad gemeten
Metrische aansluitingen

dichtknus m/wartelmoer		pijpeind		uitwendige DIN 3853		draad DIN 7631	
draad		DIN 7606/ 7631 slang nw.		Snijringkoppeling DIN 2353, RA/serie		Snijringkop. Frans	
D d				LL L S	Ø-gaz RA		
M 8x1	8,0	6,9	DN 2,5	4 LL			
M 10x1	10,0	8,9	DN 3	6 LL			
M 12x1	12,0	10,9		8 LL			
M 12x1,5	12,0	10,4	DN 4		6 L		
M 14x1,5	14,0	12,4	DN 6		8 L	6 S	
M 16x1,5	16,0	14,4	DN 8		10 L	8 S	1/8"
M 18x1,5	18,0	16,4	DN 10		12 L	10 S	10,00
M 20x1,5	20,0	18,4				12 S	1/4"
M 22x1,5	22,0	20,4	DN 12		15 L	14 S	
M 24x1,5	24,0	22,4				16 S	3/8"
M 26x1,5	26,0	24,4	DN 16		18 L		16,75
M 30x1,5	30,0	28,4	DN 20			20 S	1/2"
M 30x2	30,0	27,8			22 L		
M 36x1,5	36,0	34,4				25 S	3/4"
M 36x2	36,0	33,8			28 L		26,75
M 38x1,5	38,0	36,4	DN 25				
M 42x2	42,0	39,8				30 S	
M 45x1,5	45,0	43,4	DN 32				1"
M 45x2	45,0	42,8			35 L		
M 52x1,5	52,0	50,4	DN 40				1 1/4"
M 52x2	52,0	49,8			42 L	38 S	42,25
M 65x2	65,0	62,8	DN 50				
M 78x2	78,0	75,8	DN 60				
M 90x2	90,0	87,8	DN 70				
M 100x2	100,0	97,8	DN 80				

RA = buitenmaat pijpeind en binnenmaat snijringkoppeling
Amerikaanse aansluitingen

JIC			SAE			
dichtknus		uitw. draad	dichtknus		uitw. draad	
uitw. Ø		draad gangen soort op 1"	D mm	d mm	JIC (maat)	SAE (maat)
5/16	24	UNF	7,9	6,8	- 2	- 2
3/8	24	UNF	9,5	8,4	- 3	- 3
7/16	20	UNF	11,1	9,8	- 4	- 4
1/2	20	UNF	12,7	11,4	- 5	- 5
9/16	18	UNF	14,3	12,8	- 6	
5/8	18	UNF	15,9	14,4		- 6
3/4	16	UNF	19,1	17,4	- 8	- 8
7/8	14	UNF	22,2	20,3	- 10	- 10
1 1/16	12	UN	27,0	24,8	- 12	
1 1/8	14	UNS	27,0	25,1		- 12
1 3/16	12	UN	30,2	28,0	- 14	
1 5/16	12	UN	33,3	31,1	- 16	
1 7/8	12	UN	41,3	39,0	- 20	
1 7/8	12	UN	47,6	45,4	- 24	
2 1/2	12	UN	63,5	61,3	- 32	
3	12	UN	76,2	74,0	- 40	
3 1/2	12	UN	88,9	86,7	- 48	

BSP/NPT aansluitingen

Withworth draad				Amerikaanse stan. draad			
dichtknus		uitw. draad		NPTF			
Afm.		draad gangen op 1"	D mm	d mm	draad gangen op 1"		D mm
R 1/8"	28	9,7	8,6	1/8"NPTF	27	10,3	
R 1/4"	19	13,2	11,5	1/4"NPTF	18	13,7	
R 3/8"	19	16,7	15,0	3/8"NPTF	18	17,2	
R 1/2"	14	21,0	18,6	1/2"NPTF	14	21,3	
R 5/8"	14	22,9	20,6				
R 3/4"	14	26,4	24,1	3/4"NPTF	14	26,7	
R1"	11	33,3	30,3	1"NPTF	11 1/2	33,4	
R1 1/4"	11	41,9	39,0	1 1/4"NPTF	11 1/2	42,2	
R1 1/2"	11	47,8	44,9	1 1/2"NPTF	11 1/2	48,3	
R2"	11	59,6	56,7	2"NPTF	11 1/2	60,3	
R2 1/2"	11	75,2	72,2	2 1/2"NPTF	8	73,0	
R3"	11	87,9	84,9	3"NPTF	8	88,9	

SAE Flensaansluitingen

Bevestigiger				SAE Flens					
Flens Afm. Size		3000 PSI				6000 PSI			
		A	B	C	E	A	B	C	E
1/2"	- 8	38,1	17,5	30,2	6,7	40,5	18,2	31,8	7,8
3/4"	- 12	47,6	22,2	38,1	6,7	50,8	23,8	41,3	8,8
1"	- 16	52,4	26,2	44,5	8,0	57,2	27,8	47,6	9,5
1 1/4"	- 20	58,7	30,2	50,8	8,0	66,7	31,8	54,0	10,3
1 1/2"	- 24	69,9	35,7	60,3	8,0	79,4	36,5	63,5	12,6
2"	- 32	77,8	42,9	71,4	9,5	96,8	44,5	79,4	12,6
2 1/2"	- 40	88,9	50,8	84,1	9,5				
3"	- 48	106,4	61,9	101,6	9,5				
3 1/2"	- 56	120,7	69,9	114,3	11,2				
4"	- 64	130,2	77,8	127,0	11,2				
5"	- 80	152,4	92,1	152,4	11,2				

Huls 1SN - 1SC - 2SC

Niet schillen

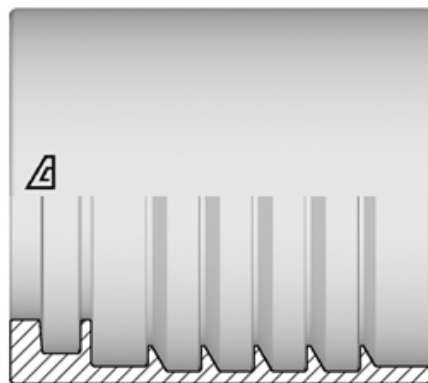

Artikelcode	Ø Slang	Staalnlage
AGCF041CNS	1/4"	1SC / B051
AGCF041NS	1/4"	1SN / 2SC
AGCF051CNS	5/16"	1SC / B051
AGCF051NS	5/16"	1SN / 2SC
AGCF061CNS	3/8"	1SN / B081
AGCF061NS	3/8"	1SN / 2SC
AGCF081NS	1/2"	1SN / 1SC / 2SC
AGCF101NS	5/8"	1SN / 1SC / 2SC
AGCF121NS	3/4"	1SN / 1SC / 2SC
AGCF161NS	1"	1SN / 1SC / 2SC
AGCF201NS	1.1/4"	1SN
AGCF241NS	1.1/2"	1SN
AGCF321NS	2"	1SN



Huls 2SN

Niet schillen

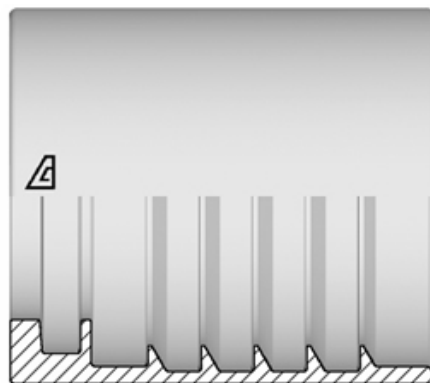

Artikelcode	Ø Slang	Staalnlage
AGCF042	1/4"	2SN
AGCF052	5/16"	2SN
AGCF062	3/8"	2SN
AGCF082	1/2"	2SN
AGCF102	5/8"	2SN
AGCF122	3/4"	2SN
AGCF162	1"	2SN
AGCF202	1.1/4"	2SN
AGCF242	1.1/2"	2SN
AGCF322	2"	2SN



Huls 1SN - 2SC

Schillen

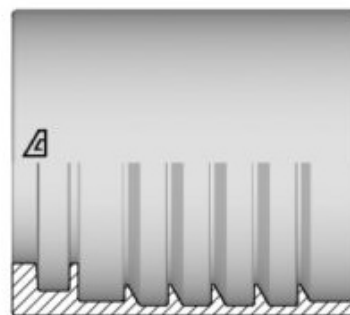

Artikelcode	Ø Slang	Slangtype
AGCF041A	1/4"	1SN / 1SN BHT / 2SC MT
AGCF051A	5/16"	1SN / 1SN BHT / B052 / 2SC MT
AGCF061A	3/8"	1SN / 1SN BHT / B062 / 2SC MT
AGCF081A	1/2"	1SN / 1SN BHT / B082 / 2SC MT
AGCF101A	5/8"	1SN / 1SN BHT / 2SC MT
AGCF121A	3/4"	1SN / 1SN BHT / 2SC MT
AGCF161A	1"	1SN / 1SN BHT / 2SC MT
AGCF201A	1.1/4"	1SN / 1SN BHT
AGCF241A	1.1/2"	1SN / 1SN BHT
AGCF321A	2"	1SN / 1SN BHT



Huls 2SN - 4SP

Schillen

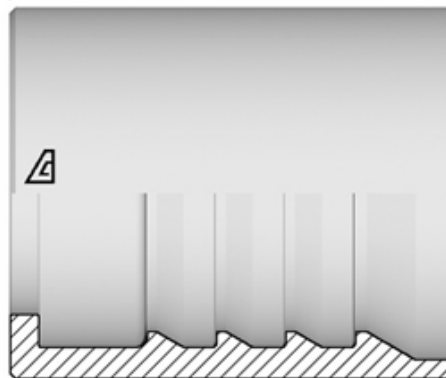

Artikelcode	Ø Slang	Slangtype
AGCF042A	1/4"	2SN /
AGCF052A	5/16"	2SN /
AGCF062A	3/8"	2SN / 4SP
AGCF082A	1/2"	2SN / 4SP
AGCF102A	5/8"	2SN / 4SP
AGCF122A	3/4"	2SN / 4SP
AGCF162A	1"	2SN / 4SP
AGCF202A	1.1/4"	2SN / 4SP
AGCF242A	1.1/2"	2SN
AGCF322A	2"	2SN



Huls 4SH - R13 - R15

INTERLOCK

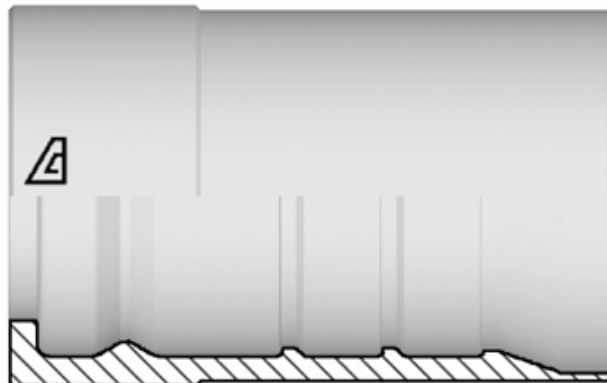

Artikelcode	Ø Slang	Slangtype
AGHF124SH	3/4"	4SH / R13 / R15
AGHF164SH	1"	4SH / R15
AGHF204SH	1.1/4"	4SH
AGHF206SH	1.1/4"	R13 / R15
AGHF244SH	1.1/2"	4SH
AGHF246SH	1.1/2"	R13 / R15
AGHF326SH	2"	R13



Huls Teflonslang

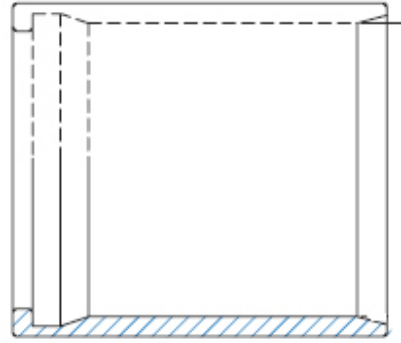

Artikelcode	Ø Slang
CFTEF04	1/4"
CFTEF05	5/16"
CFTEF06	3/8"
CFTEF08	1/2"
CFTEF10	5/8"
CFTEF12	3/4"
CFTEF16	1"
CFTEF20	1.1/4"
CFTEF24	1.1/2"
CFTEF32	2"



Huls R7 / R8

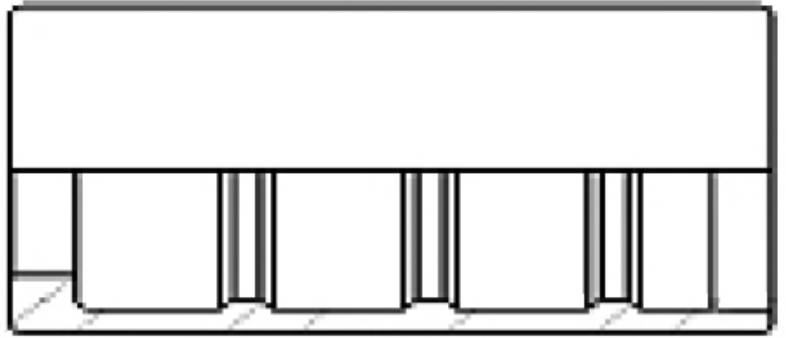

Artikelcode	Ø Slang
H702	1/8"
H703	3/16"
H704	1/4"
H705	5/16"
H706	3/8"
H708	1/2"
H710	5/8"
H712	3/4"
H716	1"



Wartelkoppeling met 60° conus BSP FEMALE

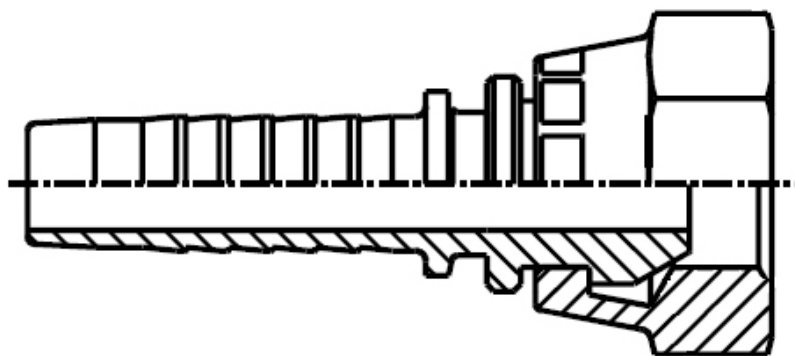

Artikelcode	Draadmaat	Ø Slang
C02BF03	1/8"	3/16"
C04BF03	1/4"	3/16"
C02BF04	1/8"	1/4"
C04BF04	1/4"	1/4"
C06BF04	3/8"	1/4"
C08BF04	1/2"	1/4"
C04BF05	1/4"	5/16"
C06BF05	3/8"	5/16"
C08BF05	1/2"	5/16"
C04BF06	1/4"	3/8"
C06BF06	3/8"	3/8"
C08BF06	1/2"	3/8"
C06BF08	3/8"	1/2"
C08BF08	1/2"	1/2"
C10BF08	5/8"	1/2"
C12BF08	3/4"	1/2"
C08BF10	1/2"	5/8"
C10BF10	5/8"	5/8"
C12BF10	3/4"	5/8"
C12BF12	3/4"	3/4"
C16BF12	1"	3/4"
C16BF16	1"	1"
C20BF16	1.1/4"	1"
C20BF20	1.1/4"	1.1/4"
C24BF20	1.1/2"	1.1/4"
C24BF24	1.1/2"	1.1/2"
C32BF24	2"	1.1/2"
C32BF32	2"	2"



45° Wartelkoppeling met 60° conus BSP FEMALE

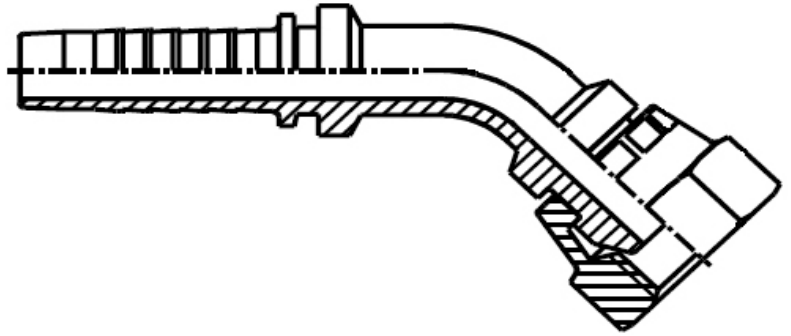

Artikelcode	Draadmaat	Ø Slang
C02B4503	1/8"	3/16"
C04B4503	1/4"	3/16"
C04B4504	1/4"	1/4"
C02B4504	1/8"	1/4"
C06B4504	3/8"	1/4"
C08B4504	1/2"	1/4"
C04B4505	1/4"	5/16"
C06B4505	3/8"	5/16"
C08B4505	1/2"	5/16"
C04B4506	1/4"	3/8"
C06B4506	3/8"	3/8"
C08B4506	1/2"	3/8"
C06B4508	3/8"	1/2"
C08B4508	1/2"	1/2"
C10B4508	5/8"	1/2"
C12B4508	3/4"	1/2"
C08B4510	1/2"	5/8"
C10B4510	5/8"	5/8"
C12B4510	3/4"	5/8"
C12B4512	3/4"	3/4"
C16B4512	1"	3/4"
C16B4516	1"	1"
C20B4516	1.1/4"	1"
C20B4520	1.1/4"	1" 1/4
C24B4520	1.1/2"	1" 1/4
C24B4524	1.1/2"	1" 1/2
C32B4524	2"	1" 1/2
C32B4532	2"	2"



90° Wartelkoppeling met 60° conus BSP FEMALE

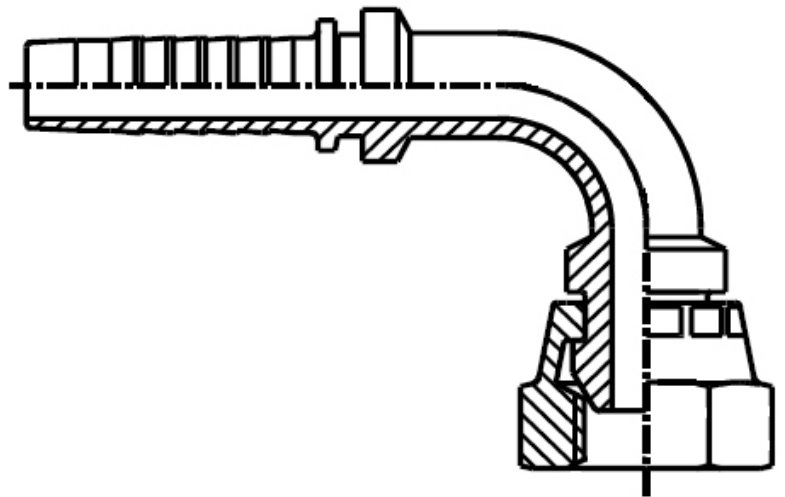

Artikelcode	Draadmaat	Ø Slang
C02B9003	1/8"	3/16"
C04B9003	1/4"	3/16"
C02B9004	1/8"	1/4"
C04B9004	1/4"	1/4"
C06B9004	3/8"	1/4"
C08B9004	1/2"	1/4"
C04B9005	1/4"	5/16"
C06B9005	3/8"	5/16"
C08B9005	1/2"	5/16"
C04B9006	1/4"	3/8"
C06B9006	3/8"	3/8"
C08B9006	1/2"	3/8"
C06B9008	3/8"	1/2"
C08B9008	1/2"	1/2"
C10B9008	5/8"	1/2"
C12B9008	3/4"	1/2"
C08B9010	1/2"	5/8"
C10B9010	5/8"	5/8"
C12B9010	3/4"	5/8"
C12B9012	3/4"	3/4"
C16B9012	1"	3/4"
C16B9016	1"	1"
C20B9016	1.1/4"	1"
C20B9020	1.1/4"	1" 1/4
C24B9020	1.1/2"	1" 1/4
C24B9024	1.1/2"	1" 1/2
C32B9024	2"	1" 1/2
C32B9032	2"	2"



**90° Korte
wartelkoppeling
met 60° conus
BSP FEMALE**

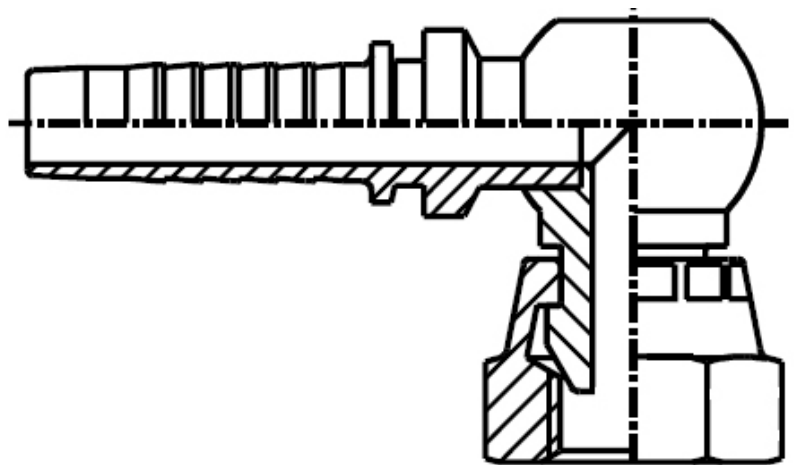

Artikelcode	Draadmaat	Ø Slang
C04B90K04	1/4"	1/4"
C06B90K06	3/8"	3/8"
C08B90K06	1/2"	3/8"
C08B90K08	1/2"	1/2"
C12B90K12	3/4"	3/4"
C16B90K16	1"	1"



**Koppeling,
buitendraad met 60°
conus
BSP MALE**

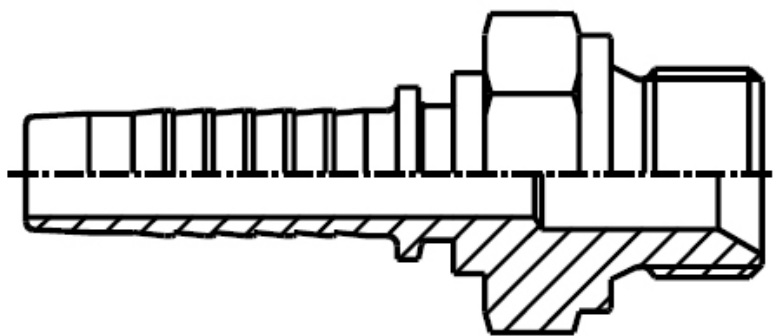

Artikelcode	Draadmaat	Ø Slang
C02BM03	1/8"	3/16"
C04BM03	1/4"	3/16"
C02BM04	1/8"	1/4"
C04BM04	1/4"	1/4"
C06BM04	3/8"	1/4"
C08BM04	1/2"	1/4"
C04BM05	1/4"	5/16"
C06BM05	3/8"	5/16"
C08BM05	1/2"	5/16"
C04BM06	1/4"	3/8"
C06BM06	3/8"	3/8"
C08BM06	1/2"	3/8"
C06BM08	3/8"	1/2"
C08BM08	1/2"	1/2"
C12BM08	3/4"	1/2"
C08BM10	1/2"	5/8"
C12BM10	3/4"	5/8"
C12BM12	3/4"	3/4"
C16BM12	1"	3/4"
C16BM16	1"	1"
C20BM16	1" 1/4	1"
C20BM20	1" 1/4	1" 1/4
C24BM20	1" 1/2	1" 1/4
C24BM24	1" 1/2	1" 1/2
C32BM24	2"	1" 1/2
C32BM32	2"	2"

C06BM06SW 3/8" SWIVEL 3/8"



Wartelkoppeling vlakdichtend BSP FEMALE

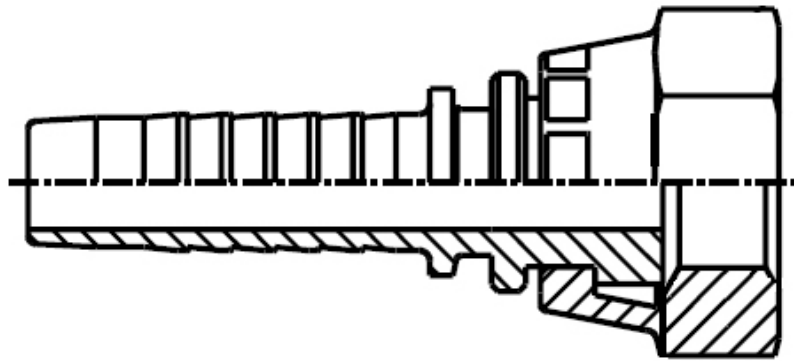

Artikelcode	Draadmaat	Ø Slang
C04BFF04	1/4"	1/4"
C06BFF04	3/8"	1/4"
C06BFF06	3/8"	3/8"
C08BFF06	1/2"	3/8"
C08BFF08	1/2"	1/2"
C12BFF08	3/4"	1/2"
C12BFF10	3/4"	5/8"
C12BFF12	3/4"	3/4"
C16BFF12	1"	3/4"
C16BFF16	1"	1"



**Koppeling,
buitendraad
vlakdichtend
BSP MALE**

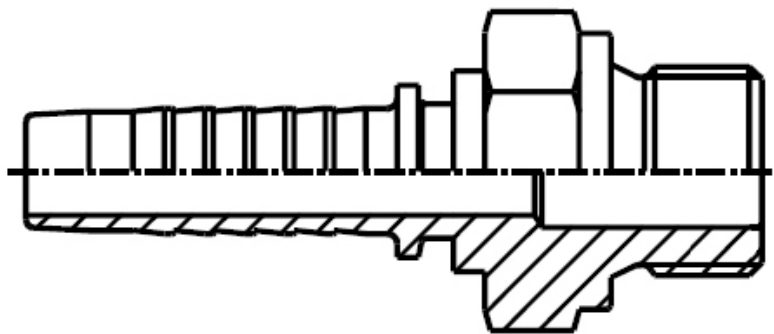

Artikelcode	Draadmaat	Ø Slang
C04BMF04	1/4"	1/4"
C06BMF04	3/8"	1/4"
C06BMF06	3/8"	3/8"
C08BMF08	1/2"	1/2"
C16BMF16	1"	1"



**Koppeling,
conische
buitendraad met 60°
conus
BSPT MALE**

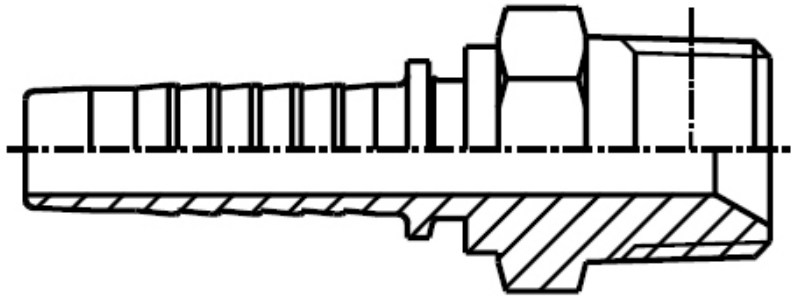

Artikelcode	Draadmaat	Ø Slang
C04BMT04	1/4"	1/4"
C06BMT04	3/8"	1/4"
C06BMT05	3/8"	5/16"
C04BMT06	1/4"	3/8"
C06BMT06	3/8"	3/8"
C08BMT06	1/2"	3/8"
C06BMT08	3/8"	1/2"
C08BMT08	1/2"	1/2"
C12BMT10	3/4"	5/8"
C12BMT12	3/4"	3/4"
C16BMT16	1"	1"
C20BMT20	1" 1/4	1" 1/4
C24BMT24	1" 1/2	1" 1/2
C32BMT32	2"	2"



Banjo-oog

BSP



Artikelcode	Ø Banjo-oog	Ø Slang
C02BAB04	1/8"	1/4"
C04BAB04	1/4"	1/4"
C06BAB04	3/8"	1/4"
C04BAB05	1/4"	5/16"
C06BAB05	3/8"	5/16"
C08BAB05	1/2"	5/16"
C04BAB06	1/4"	3/8"
C06BAB06	3/8"	3/8"
C08BAB06	1/2"	3/8"
C06BAB08	3/8"	1/2"
C08BAB08	1/2"	1/2"
C12BAB12	3/4"	3/4"
C16BAB12	1"	3/4"
C12BAB16	3/4"	1"
C16BAB16	1"	1"

Banjo-bout

BSP

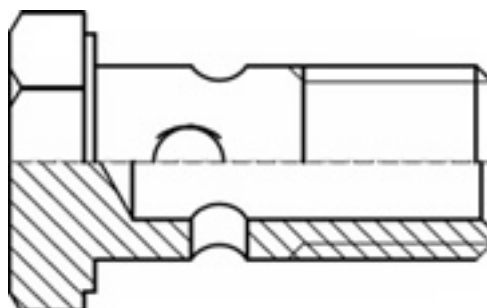

Artikelcode	Ø Banjo-bout
F1502BM	1/8"
F1504BM	1/4"
F1506BM	3/8"
F1508BM	1/2"
F1510BM	5/8"
F1512BM	3/4"
F1516BM	1"



**Wartelkoppeling
met 24° conus en
o-ring DKOL-serie
METRISCH FEMALE
DIN 2353**

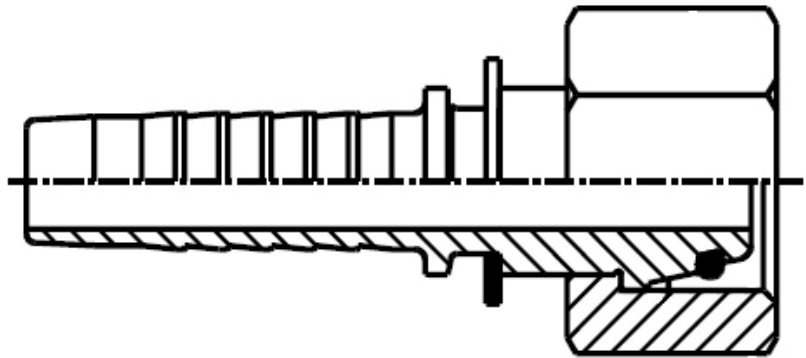

Artikelcode	Draadmaat	Pijpmaat in mm	Ø Slang
C12DF06L03	M12x1.5	6	3/16"
C12DF06L04	M12x1.5	6	1/4"
C14DF08L04	M14x1.5	8	1/4"
C16DF10L04	M16x1.5	10	1/4"
C18DF12L04	M18x1.5	12	1/4"
C12DF06L05	M12x1.5	6	5/16"
C16DF10L05	M16x1.5	10	5/16"
C18DF12L05	M18x1.5	12	5/16"
C16DF10L06	M16x1.5	10	3/8"
C18DF12L06	M18x1.5	12	3/8"
C22DF15L06	M22x1.5	15	3/8"
C18DF12L08	M18x1.5	12	1/2"
C22DF15L08	M22x1.5	15	1/2"
C26DF18L08	M26x1.5	18	1/2"
C22DF15L10	M22x1.5	15	5/8"
C26DF18L10	M26x1.5	18	5/8"
C30DF22L10	M30x2	22	5/8"
C30DF22L12	M30x2	22	3/4"
C36DF28L16	M36x2	28	1"
C45DF35L16	M45x2	35	1"
C45DF35L20	M45x2	35	1.1/4"
C52DF42L24	M52x2	42	1.1/2"



**45° Wartelkoppeling
met 24° conus en
o-ring DKOL-serie
METRISCH FEMALE
DIN 3865**

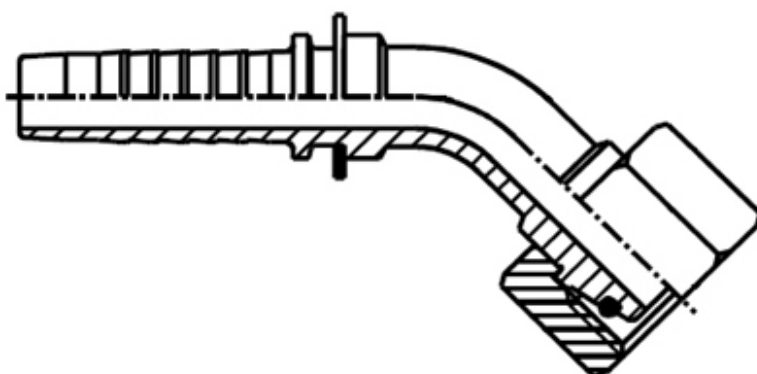

Artikelcode	Draadmaat	Pijpmaat in mm	Ø Slang
C12D4506L03	M12x1.5	6	3/16"
C12D4506L04	M12x1.5	6	1/4"
C14D4508L04	M14x1.5	8	1/4"
C16D4510L04	M16x1.5	10	1/4"
C18D4512L04	M18x1.5	12	1/4"
C16D4510L05	M16x1.5	10	5/16"
C18D4512L05	M18x1.5	12	5/16"
C16D4510L06	M16x1.5	10	3/8"
C18D4512L06	M18x1.5	12	3/8"
C22D4515L06	M22x1.5	15	3/8"
C22D4515L08	M22x1.5	15	1/2"
C26D4518L08	M26x1.5	18	1/2"
C26D4518L10	M26x1.5	18	5/8"
C30D4522L10	M30x2	22	5/8"
C30D4522L12	M30x2	22	3/4"
C36D4528L16	M36x2	28	1"
C45D4535L16	M45x2	35	1"
C45D4535L20	M45x2	35	1.1/4"
C52D4542L24	M52x2	42	1.1/2"



**90° Wartelkoppeling
met 24° conus en
o-ring DKOL-serie
METRISCH FEMALE
DIN 3835**

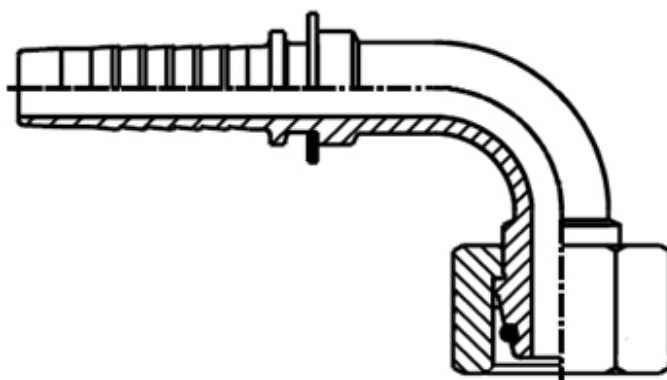

Artikelcode	Draadmaat	Pijpmaat in mm	Ø Slang
C12D9006L03	M12x1.5	6	3/16"
C12D9006L04	M12x1.5	6	1/4"
C14D9008L04	M14x1.5	8	1/4"
C16D9010L04	M16x1.5	10	1/4"
C18D9012L04	M18x1.5	12	1/4"
C16D9010L05	M16x1.5	10	5/16"
C18D9012L05	M18x1.5	12	5/16"
C16D9010L06	M16x1.5	10	3/8"
C18D9012L06	M18x1.5	12	3/8"
C22D9015L06	M22x1.5	15	3/8"
C18D9012L08	M18x1.5	12	1/2"
C22D9015L08	M22x1.5	15	1/2"
C26D9018L08	M26x1.5	18	1/2"
C26D9018L10	M26x1.5	18	5/8"
C30D9022L10	M30x2	22	5/8"
C30D9022L12	M30x2	22	3/4"
C36D9028L16	M36x2	28	1"
C45D9035L16	M45x2	35	1"
C45D9035L20	M45x2	35	1.1/4"
C52D9042L24	M52x2	42	1.1/2"



**Wartelkoppeling
met 24° conus en
o-ring DKOS-serie
METRISCH FEMALE
DIN 2353**

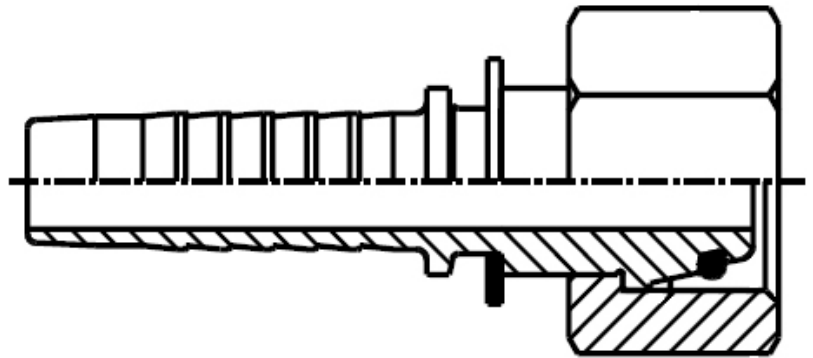

Artikelcode	Draadmaat	Pijpmaat in mm	Ø Slang
C14DF06S03	M14x1.5	6	3/16"
C14DF06S04	M14x1.5	6	1/4"
C16DF08S04	M16x1.5	8	1/4"
C18DF10S04	M18x1.5	10	1/4"
C20DF12S04	M20x1.5	12	1/4"
C18DF10S05	M18x1.5	10	5/16"
C20DF12S05	M20x1.5	12	5/16"
C18DF10S06	M18x1.5	10	3/8"
C20DF12S06	M20x1.5	12	3/8"
C22DF14S06	M22x1.5	14	3/8"
C22DF14S08	M22x1.5	14	1/2"
C24DF16S08	M24x1.5	16	1/2"
C30DF20S10	M30x2	20	5/8"
C30DF20S12	M30x2	20	3/4"
C36DF25S12	M36x2	25	3/4"
C36DF25S16	M36x2	25	1"
C42DF30S16	M42x2	30	1"
C52DF38S20	M52x2	38	1.1/4"
C52DF38S24	M52x2	38	1.1/2"
C36DF25S12SW41	M36x2 SLEUTEL- WIJDTE 41	25	3/4"



**45° Wartelkoppeling
met 24° conus en
o-ring DKOS-serie
METRISCH FEMALE
DIN 3865**

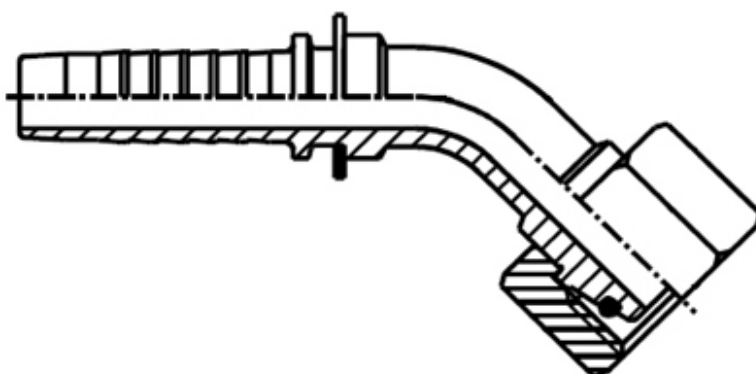

Artikelcode	Draadmaat	Pijpmaat in mm	Ø Slang
C14D4506S04	M14x1.5	6	1/4"
C16D4508S04	M16x1.5	8	1/4"
C18D4510S04	M18x1.5	10	1/4"
C18D4510S05	M18x1.5	10	5/16"
C20D4512S05	M20x1.5	12	5/16"
C18D4510S06	M18x1.5	10	3/8"
C20D4512S06	M20x1.5	12	3/8"
C22D4514S06	M22x1.5	14	3/8"
C22D4514S08	M22x1.5	14	1/2"
C24D4516S08	M24x1.5	16	1/2"
C30D4520S10	M30x2	20	5/8"
C30D4520S12	M30x2	20	3/4"
C36D4525S12	M36x2	25	3/4"
C36D4525S16	M36x2	25	1"
C42D4530S16	M42x2	30	1"
C52D4538S20	M52x2	38	1.1/4"
C52D4538S24	M52x2	38	1.1/2"
C36D4525S12SW41	M36x2 SLEUTEL- WIJDTE 41	25	3/4"



**90° Wartelkoppeling
met 24° conus en
o-ring DKOS-serie
METRISCH FEMALE
DIN 3865**

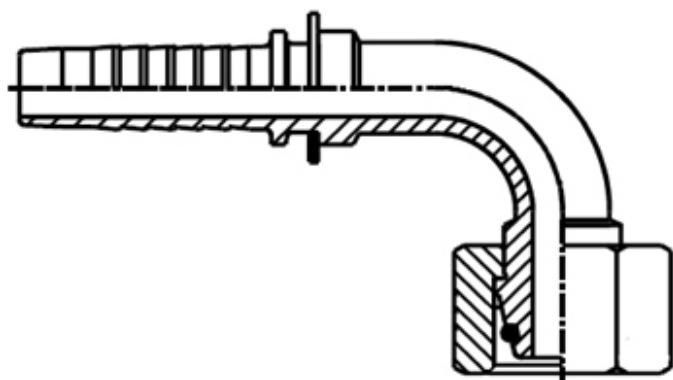

Artikelcode	Draadmaat	Pijpmaat in mm	Ø Slang
C14D9006S03	M14x1.5	6	3/16"
C14D9006S04	M14x1.5	6	1/4"
C16D9008S04	M16x1.5	8	1/4"
C18D9010S04	M18x1.5	10	1/4"
C20D9012S04	M20x1.5	12	1/4"
C18D9010S05	M18x1.5	10	5/16"
C20D9012S05	M20x1.5	12	5/16"
C18D9010S06	M18x1.5	10	3/8"
C20D9012S06	M20x1.5	12	3/8"
C22D9014S06	M22x1.5	14	3/8"
C22D9014S08	M22x1.5	14	1/2"
C24D9016S08	M24x1.5	16	1/2"
C30D9020S10	M30x2	20	5/8"
C30D9020S12	M30x2	20	3/4"
C36D9025S12	M36x2	25	3/4"
C36D9025S16	M36x2	25	1"
C42D9030S16	M42x2	30	1"
C52D9038S20	M52x2	38	1.1/4"
C52D9038S24	M52x2	38	1.1/2"
C36D9025S12SW41	M36x2 SLEUTEL- WIJDTE 41	25	3/4"



**Koppeling,
buitendraad met 60°
conus
METRISCH MALE**

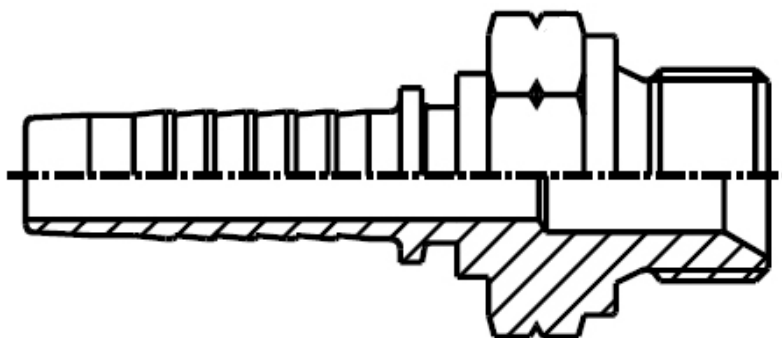

Artikelcode	Draadmaat	Ø Slang
C10DM03	M10x1.5	3/16"
C12DM03	M12x1.5	3/16"
C10DM04	M10x1.5	1/4"
C12DM04	M12x1.5	1/4"
C14DM04	M14x1.5	1/4"
C16DM04	M16x1.5	1/4"
C18DM04	M18x1.5	1/4"
C14DM05	M14x1.5	5/16"
C16DM05	M16x1.5	5/16"
C18DM05	M18x1.5	5/16"
C14DM06	M14x1.5	3/8"
C16DM06	M16x1.5	3/8"
C18DM06	M18x1.5	3/8"
C18DM08	M18x1.5	1/2"
C22DM08	M22x1.5	1/2"
C24DM08	M24x1.5	1/2"
C26DM10	M26x1.5	5/8"
C26DM12	M26x1.5	3/4"
C30DM12	M30x1.5	3/4"



Koppeling met buitendraad voor snijringmontage, met 24° conus, L-serie

**METRISCH MALE
DIN 3853**

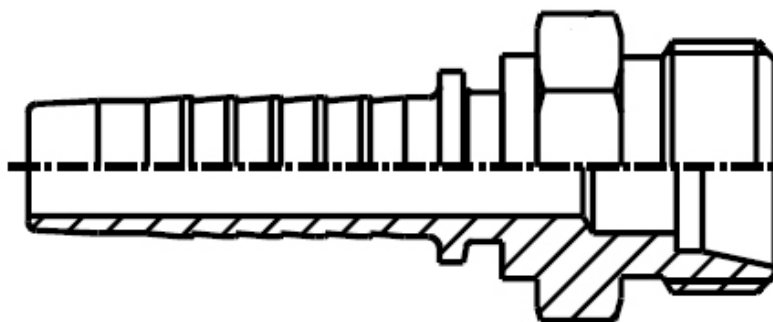

Artikelcode	Draadmaat	Pijpmaat in mm	Ø Slang
C12ME06L03	M12x1.5	6	3/16"
C12ME06L04	M12x1.5	6	1/4"
C14ME08L04	M14x1.5	8	1/4"
C16ME10L04	M16x1.5	10	1/4"
C18ME12L04	M18x1.5	12	1/4"
C16ME10L05	M16x1.5	10	5/16"
C18ME12L05	M18x1.5	12	5/16"
C16ME10L06	M16x1.5	10	3/8"
C18ME12L06	M18x1.5	12	3/8"
C22ME15L06	M22x1.5	15	3/8"
C22ME15L08	M22x1.5	15	1/2"
C26ME18L08	M26x1.5	18	1/2"
C26ME18L10	M26x1.5	18	5/8"
C30ME22L10	M30x2	22	5/8"
C26ME18L12	M26x2	18	3/4"
C30ME22L12	M30x2	22	3/4"
C36ME28L16	M36x2	28	1"
C45ME35L20	M45x2	35	1.1/4"
C52ME42L24	M52x2	42	1.1/2"



Koppeling met buitendraad voor snijringmontage, met 24° conus, S-serie

**METRISCH MALE
DIN 3853**

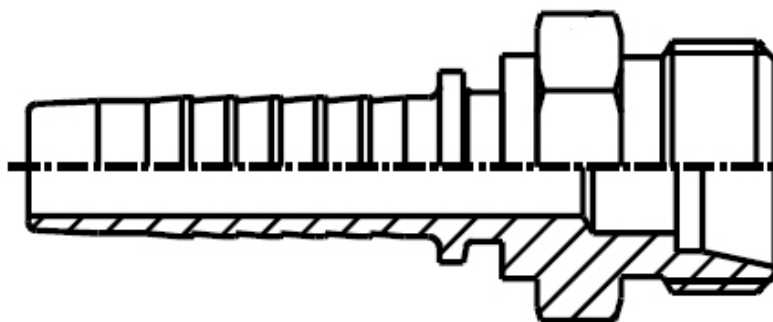

Artikelcode	Draadmaat	Pijpmaat in mm	Ø Slang
C14ME06S03	M14x1.5	6	3/16"
C16ME08S03	M16x1.5	8	3/16"
C14ME06S04	M14x1.5	6	1/4"
C16ME08S04	M16x1.5	8	1/4"
C18ME10S04	M18x1.5	10	1/4"
C18ME10S05	M18x1.5	10	5/16"
C20ME12S05	M20x1.5	12	5/16"
C18ME10S06	M18x1.5	10	3/8"
C20ME12S06	M20x1.5	12	3/8"
C22ME14S06	M22x1.5	14	3/8"
C22ME14S08	M22x1.5	14	1/2"
C24ME16S08	M24x1.5	16	1/2"
C30ME20S10	M30x2	20	5/8"
C30ME20S12	M30x2	20	3/4"
C36ME25S12	M36x2	25	3/4"
C36ME25S16	M36x2	25	1"
C42ME30S16	M42x2	30	1"
C42ME30S20	M42x2	30	1.1/4"
C52ME38S20	M52x2	38	1.1/4"
C52ME38S24	M52x2	38	1.1/2"



90° Koppeling met buitendraad voor snijringmontage, met 24° conus, L-serie

METRISCH MALE
DIN 3853

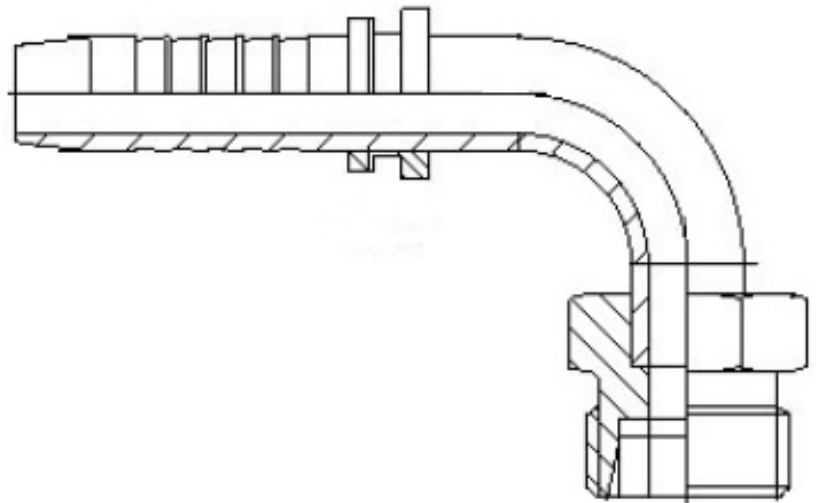

Artikelcode	Draadmaat	Pijpmaat in mm	Ø Slang
C12M9006L03	M12x1.5	6	3/16"
C14M9008L04	M14x1.5	8	1/4"
C16M9010L04	M16x1.5	10	1/4"
C18M9012L04	M18x1.5	12	1/4"
C16M9010L05	M16x1.5	10	5/16"
C16M9010L06	M16x1.5	10	3/8"
C18M9012L06	M18x1.5	12	3/8"
C22M9015L06	M22x1.5	15	3/8"
C22M9015L08	M22x1.5	15	1/2"
C26M9018L10	M26x1.5	18	5/8"
C26M9018L12	M26x1.5	18	3/4"
C30M9022L12	M30x2	22	3/4"
C36M9028L16	M36x2	28	1"
C45M9035L20	M45x2	35	1.1/4"
C52M9042L24	M52x2	42	1.1/2"



Wartelkoppeling met 60° conus

METRISCH FEMALE

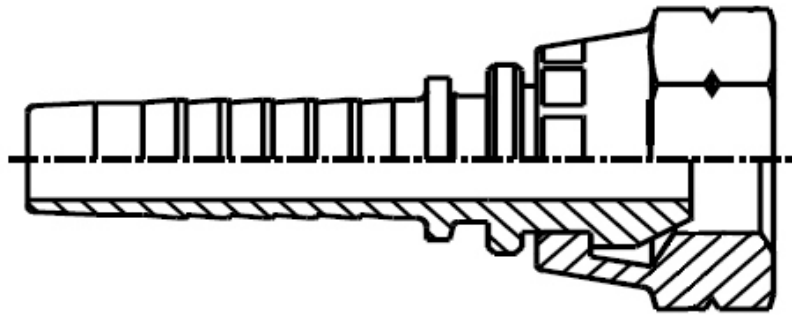

Artikelcode	Draadmaat	Ø Slang	Serie
C10DF03	M10x1	3/16"	DKL
C12DF03	M12x1.5	3/16"	DKL
C14DF03	M14x1.5	3/16"	DKL
C10DF04	M10x1.5	1/4"	DKL
C12DF04	M12x1.5	1/4"	DKL
C14DF04	M14x1.5	1/4"	DKL
C16DF04	M16x1.5	1/4"	DKL
C18DF04	M18x1.5	1/4"	DKL
C14DF05	M14x1.5	5/16"	DKL
C16DF05	M16x1.5	5/16"	DKL
C18DF05	M18x1.5	5/16"	DKL
C14DF06	M14x1.5	3/8"	DKL
C16DF06	M16x1.5	3/8"	DKL
C18DF06	M18x1.5	3/8"	DKL
C22DF06	M22x1.5	3/8"	DKL
C18DF08	M18x1.5	1/2"	DKL
C22DF08	M22x1.5	1/2"	DKL
C26DF10	M26x1.5	5/8"	DKL
C26DF12	M26x1.5	3/4"	DKL
C30DF12	M30x1.5	3/4"	DKL
C20DF06	M20x1.5	3/8"	DKS
C20DF08	M20x1.5	1/2"	DKS
C38DF16	M38x2	1"	DKS



45° Wartelkoppeling met 60° conus METRISCH FEMALE

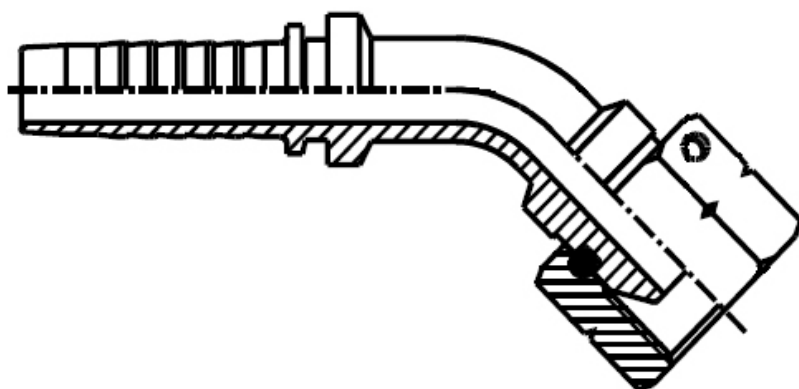

Artikelcode	Draadmaat	Ø Slang	Serie
C14D4504	M14x1.5	1/4"	DKL
C16D4505	M16x1.5	5/16"	DKL
C18D4506	M18x1.5	3/8"	DKL
C22D4508	M22x1.5	1/2"	DKL
C26D4510	M26x1.5	5/8"	DKL
C30D4512	M30x1.5	3/4"	DKL
C38D4516	M38x2	1"	DKS



90° Wartelkoppeling met 60° conus

METRISCH FEMALE

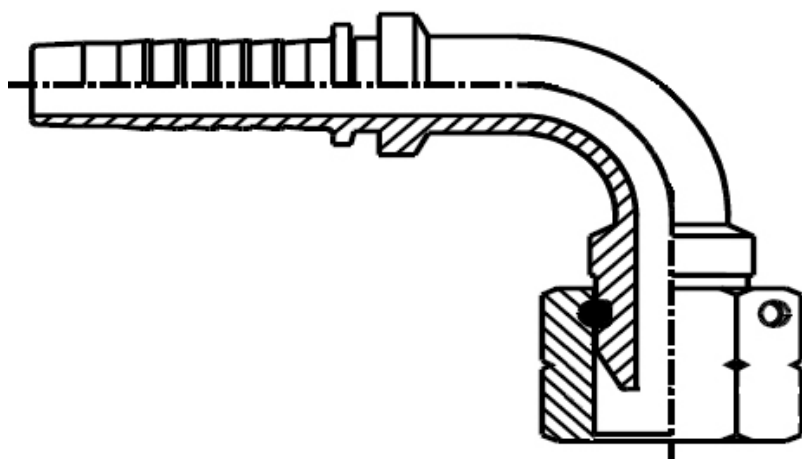

Artikelcode	Draadmaat	Ø Slang	Serie
C12D9004	M12x1.5	1/4"	DKL
C14D9004	M14x1.5	1/4"	DKL
C16D9004	M16x1.5	1/4"	DKL
C18D9004	M18x1.5	1/4"	DKL
C16D9005	M16x1.5	5/16"	DKL
C18D9005	M18x1.5	5/16"	DKL
C16D9006	M16x1.5	3/8"	DKL
C18D9006	M18x1.5	3/8"	DKL
C22D9006	M22x1.5	3/8"	DKL
C22D9008	M22x1.5	1/2"	DKL
C26D9010	M26x1.5	5/8"	DKL
C26D9012	M26x1.5	3/4"	DKL
C30D9012	M30x1.5	3/4"	DKL
C20D9006	M20x1.5	3/8"	DKS
C20D9008	M20x1.5	1/2"	DKS
C38D9016	M38x2	1"	DKS



90° Koppeling met buitendraad voor snijringmontage, met 24° conus, S-serie

METRISCH MALE
DIN 3853

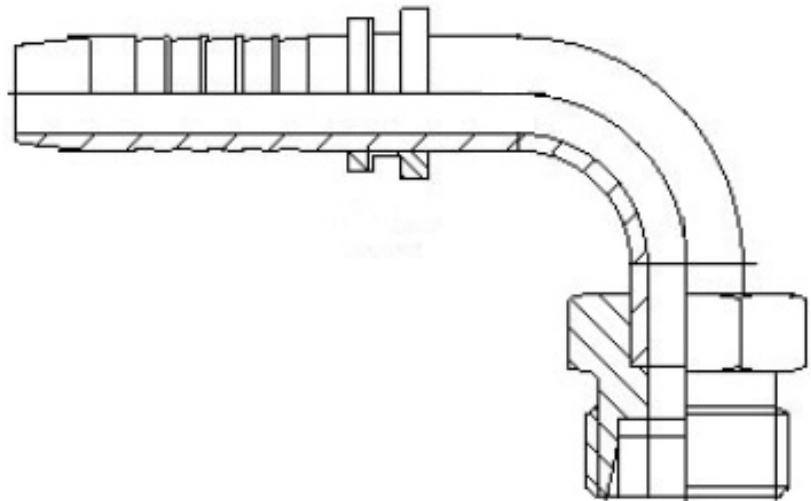

Artikelcode	Draadmaat	Pijpmaat in mm	Ø Slang
C16M9008S08	M16x1.5	8	1/2
C16M9008S08	M16x1.5	8	1/2
C18M9010S10	M18x1.5	10	5/8
C20M9012S12	M20x1.5	12	3/4
C18M9010S10	M18x1.5	10	5/8
C20M9012S12	M20x1.5	12	3/4
C22M9014S14	M22x1.5	14	7/8
C24M9016S16	M24x1.5	16	1
C30M9020S20	M30x2	20	1.1/4"
C30M9020S20	M30x2	20	1.1/4"
C36M9025S25	M36x2	25	1.9/16"
C36M9025S25	M36x2	25	1.9/16"
C42M9030S30	M42x2	30	1.7/8"
C52M9038S38	M52x2	38	2.3/8"
C52M9038S38	M52x2	38	2.3/8"



Banjo-oog

METRISCH



Artikelcode	Ø Banjo-oog	Ø Slang
C14BAM04	14mm	1/4"
C18BAM04	18mm	1/4"
C14BAM05	14mm	5/16"
C16BAM05	16mm	5/16"
C18BAM05	18mm	5/16"
C14BAM06	14mm	3/8"
C16BAM06	16mm	3/8"
C18BAM06	18mm	3/8"
C22BAM06	22mm	3/8"
C18BAM08	18mm	1/2"
C22BAM08	22mm	1/2"
C22BAM10	22mm	5/8"
C26BAM12	26mm	3/4"
C30BAM16	30mm	1"

Banjo-bout

METRISCH

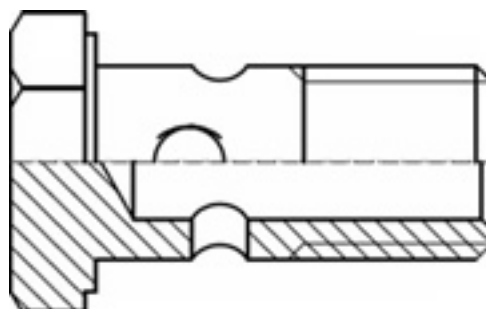

Artikelcode	Ø Banjo-bout
F15M10	M10x1
F15M12	M12x1.5
F15M14	M14x1.5
F15M16	M16x1.5
F15M18	M18x1.5
F15M20	M20x1.5
F15M22	M22x1.5



JIC Wartelkoppeling met 74° conus

UNF FEMALE

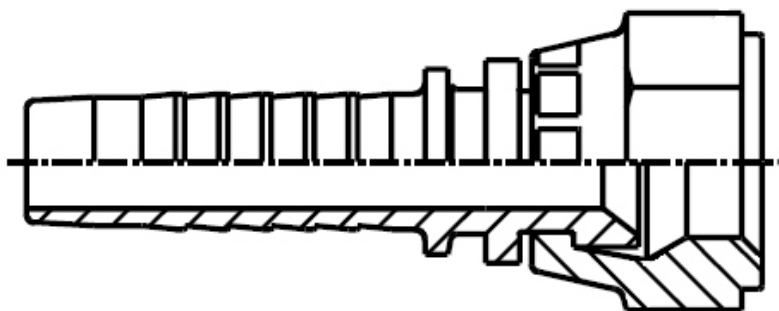

Artikelcode	Draadmaat	Ø Slang
C07JF03	7/16"	3/16"
C08JF03	1/2"	3/16"
C07JF04	7/16"	1/4"
C08JF04	1/2"	1/4"
C09JF04	9/16"	1/4"
C08JF05	1/2"	5/16"
C09JF05	9/16"	5/16"
C12JF05	3/4"	5/16"
C09JF06	9/16"	3/8"
C10JF06	5/8"	3/8"
C12JF06	3/4"	3/8"
C14JF06	7/8"	3/8"
C12JF08	3/4"	1/2"
C14JF08	7/8"	1/2"
C17JF08	1.1/16"	1/2"
C14JF10	7/8"	5/8"
C17JF10	1.1/16"	5/8"
C14JF12	7/8"	3/4"
C17JF12	1.1/16"	3/4"
C19JF12	1.3/16"	3/4"
C21JF12	1.5/16"	3/4"
C17JF16	1.1/16"	1"
C21JF16	1.5/16"	1"
C26JF16	1.5/8"	1"
C26JF20	1.5/8"	1.1/4"
C30JF20	1.7/8"	1.1/4"
C30JF24	1.7/8"	1.1/2"
C40JF32	2.1/2"	2"



45° JIC
Wartelkoppeling
met 74° conus
UNF FEMALE

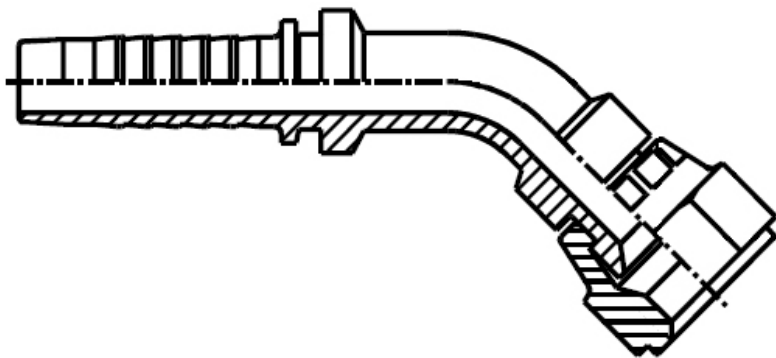

Artikelcode	Draadmaat	Ø Slang
C07J4503	7/16"	3/16"
C08J4503	1/2"	3/16"
C07J4504	7/16"	1/4"
C08J4504	1/2"	1/4"
C09J4504	9/16"	1/4"
C08J4505	1/2"	5/16"
C09J4505	9/16"	5/16"
C10J4505	5/8"	5/16"
C12J4505	3/4"	5/16"
C08J4506	1/2"	3/8"
C09J4506	9/16"	3/8"
C10J4506	5/8"	3/8"
C12J4506	3/4"	3/8"
C14J4506	7/8"	3/8"
C12J4508	3/4"	1/2"
C14J4508	7/8"	1/2"
C17J4508	1.1/16"	1/2"
C14J4510	7/8"	5/8"
C17J4510	1.1/16"	5/8"
C17J4512	1.1/16"	3/4"
C19J4512	1.3/16"	3/4"
C21J4512	1.5/16"	3/4"
C19J4516	1.3/16"	1"
C21J4516	1.5/16"	1"
C26J4520	1.5/8"	1.1/4"
C30J4520	1.7/8"	1.1/4"
C30J4524	1.7/8"	1.1/2"



90° JIC
Wartelkoppeling
met 74° conus
UNF FEMALE

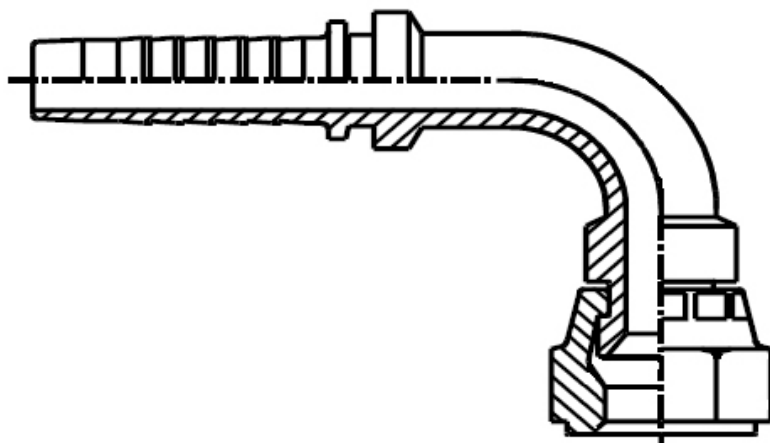

Artikelcode	Draadmaat	Ø Slang
C07J9004	7/16"	1/4"
C08J9004	1/2"	1/4"
C09J9004	9/16"	1/4"
C08J9005	1/2"	5/16"
C09J9005	9/16"	5/16"
C12J9005	3/4"	5/16"
C08J9006	1/2"	3/8"
C09J9006	9/16"	3/8"
C10J9006	5/8"	3/8"
C12J9006	3/4"	3/8"
C14J9006	7/8"	3/8"
C12J9008	3/4"	1/2"
C14J9008	7/8"	1/2"
C17J9008	1.1/16"	1/2"
C14J9010	7/8"	5/8"
C17J9010	1.1/16"	5/8"
C17J9012	1.1/16"	3/4"
C19J9012	1.3/16"	3/4"
C21J9012	1.5/16"	3/4"
C17J9016	1.1/16"	1"
C19J9016	1.3/16"	1"
C21J9016	1.5/16"	1"
C26J9016	1.5/8"	1"
C26J9020	1.5/8"	1.1/4"
C30J9020	1.7/8"	1.1/4"
C30J9024	1.7/8"	1.1/2"



**90° Korte JIC
Wartelkoppeling
met 74° conus
UNF FEMALE**

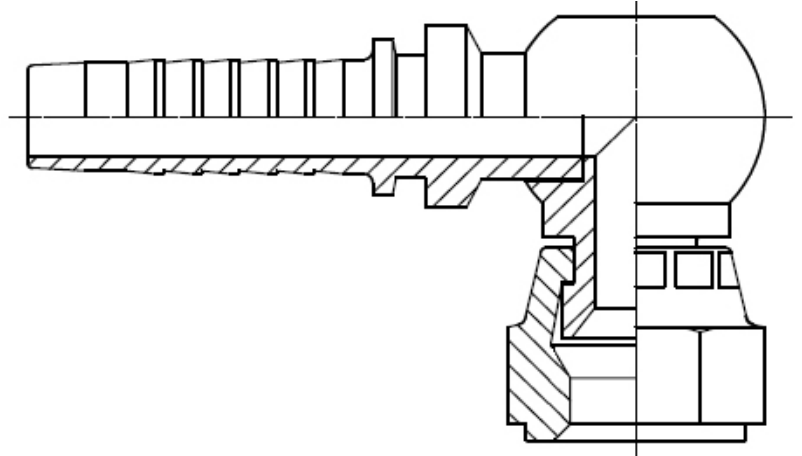

Artikelcode	Draadmaat	Ø Slang
C07J90K04	7/16"	1/4"
C08J90K04	1/2"	1/4"
C09J90K04	9/16"	1/4"
C09J90K06	9/16"	3/8"
C12J90K06	3/4"	3/8"
C12J90K08	3/4"	1/2"
C14J90K08	7/8"	1/2"
C14J90K10	7/8"	5/8"
C17J90K12	1.1/16	3/4"



**JIC Koppeling,
buitendraad met 74°
conus
UNF MALE**

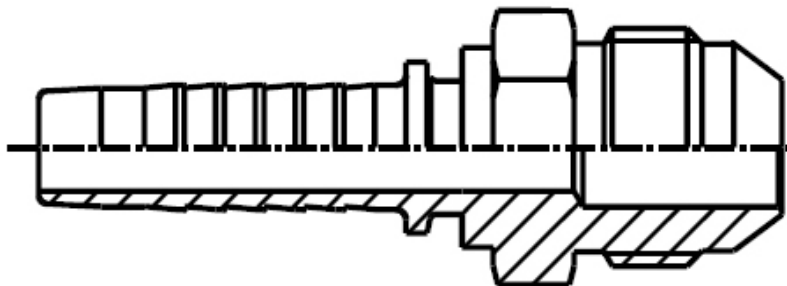

Artikelcode	Draadmaat	Ø Slang
C07JM03	7/16"	3/16"
C08JM03	1/2"	3/16"
C07JM04	7/16"	1/4"
C08JM04	1/2"	1/4"
C09JM04	9/16"	1/4"
C08JM05	1/2"	5/16"
C09JM05	9/16"	5/16"
C10JM05	5/8"	5/16"
C12JM05	3/4"	5/16"
C09JM06	9/16"	3/8"
C10JM06	5/8"	3/8"
C12JM06	3/4"	3/8"
C14JM06	7/8"	3/8"
C12JM08	3/4"	1/2"
C14JM08	7/8"	1/2"
C17JM08	1.1/16"	1/2"
C14JM10	7/8"	5/8"
C17JM10	1.1/16"	5/8"
C17JM12	1.1/16"	3/4"
C19JM12	1.3/16"	3/4"
C21JM12	1.5/16"	3/4"
C19JM16	1.3/16"	1"
C21JM16	1.5/16"	1"
C26JM16	1.5/8"	1"
C26JM20	1.5/8"	1.1/4"
C30JM20	1.7/8"	1.1/4"
C30JM24	1.7/8"	1.1/2"
C40JM32	2.1/2"	2"



Wartelkoppeling met 60° negatieve conus (JIS F) BSP FEMALE



Artikelcode	Draadmaat	Ø Slang
C04BJF04	1/4"	1/4"
C06BJF06	3/8"	3/8"
C08BJF08	1/2"	1/2"
C12BJF12	3/4"	3/4"
C16BJF16	1"	1"



Wartelkoppeling met 60° negatieve conus (Komatsu) METRISCH FEMALE



Artikelcode	Draadmaat	Ø Slang
C14MJF04	M14x1.5	1/4"
C16MJF05	M16x1.5	5/16"
C14MJF06	M14x1.5	3/8"
C18MJF06	M18x1.5	3/8"
C22MJF08	M22x1.5	1/2"
C24MJF08	M24x1.5	1/2"
C24MJF10	M24x1.5	5/8"
C30MJF12	M30x1.5	3/4"
C33MJF16	M33x1.5	1"



ORFS
Wartelkoppeling,
vlakdichtend
UNF FEMALE

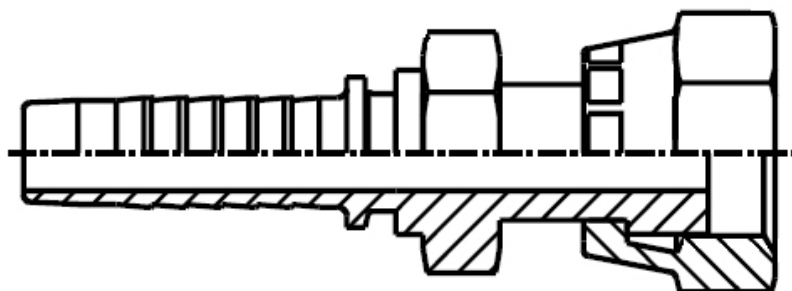

Artikelcode	Draadmaat	Ø Slang
C11LORF04	11/16"	1/4"
C13LORF04	13/16"	1/4"
C11LORF05	11/16"	5/16"
C11LORF06	11/16"	3/8"
C13LORF06	13/16"	3/8"
C13LORF08	13/16"	1/2"
C16LORF08	1"	1/2"
C16LORF10	1"	5/8"
C19LORF12	1.3/16"	3/4"
C23LORF16	1.7/16"	1"
C27LORF16	1.11/16"	1"
C27LORF20	1.11/16"	1.1/4"



45° ORFS
Wartelkoppeling,
vlakdichtend
UNF FEMALE

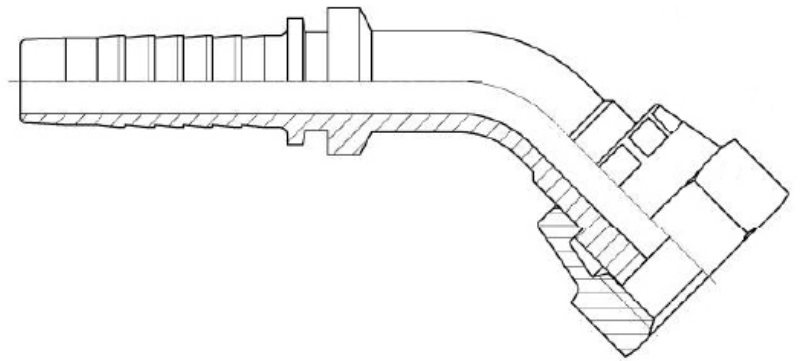

Artikelcode	Draadmaat	Ø Slang
C09LORF4504	9/16"	1/4"
C11LORF4504	11/16"	1/4"
C11LORF4505	11/16"	5/16"
C11LORF4506	11/16"	3/8"
C13LORF4506	13/16"	3/8"
C13LORF4508	13/16"	1/2"
C16LORF4508	1"	1/2"
C16LORF4510	1"	5/8"
C19LORF4512	1.3/16"	3/4"
C23LORF4516	1.7/16"	1"
C27LORF4520	1.11/16"	1.1/4"
C32LORF4524	2"	1.1/2"



90° ORFS
Wartelkoppeling,
vlakdichtend
UNF FEMALE

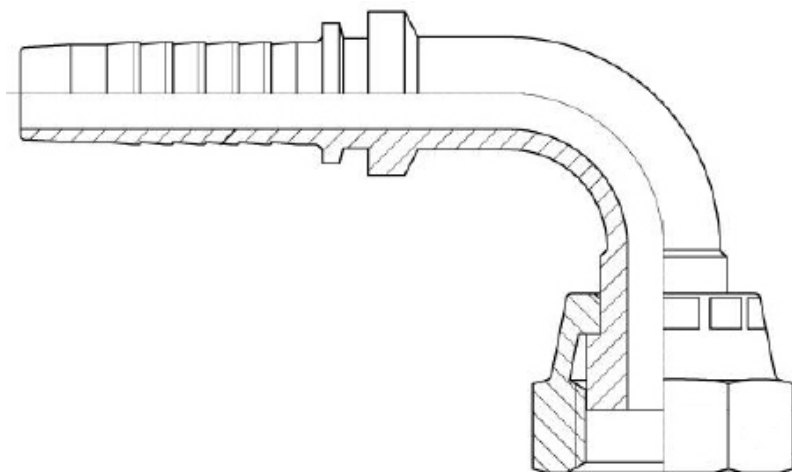

Artikelcode	Draadmaat	Ø Slang
C09LORF9004	9/16"	1/4"
C11LORF9004	11/16"	1/4"
C11LORF9005	11/16"	5/16"
C11LORF9006	11/16"	3/8"
C13LORF9006	13/16"	3/8"
C13LORF9008	13/16"	1/2"
C16LORF9008	1"	1/2"
C16LORF9010	1"	5/8"
C19LORF9012	1.3/16"	3/4"
C23LORF9016	1.7/16"	1"
C27LORF9020	1.11/16"	1.1/4"
C32LORF9024	2"	1.1/2"



**ORFS Koppeling,
buitendraad
vlakdichtend
UNF MALE**

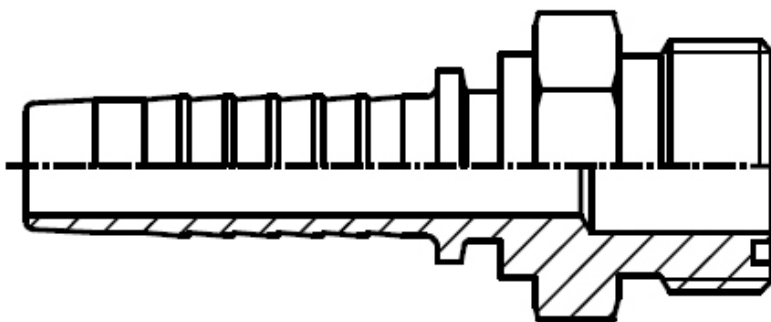

Artikelcode	Draadmaat	Ø Slang
C11LORFM06	11/16"	3/8"
C13LORFM08	13/16"	1/2"
C16LORFM10	1"	5/8"
C19LORFM12	1.3/16"	3/4"
C23LORFM16	1.7/16"	1"



Koppeling met 60° conus NPT FEMALE

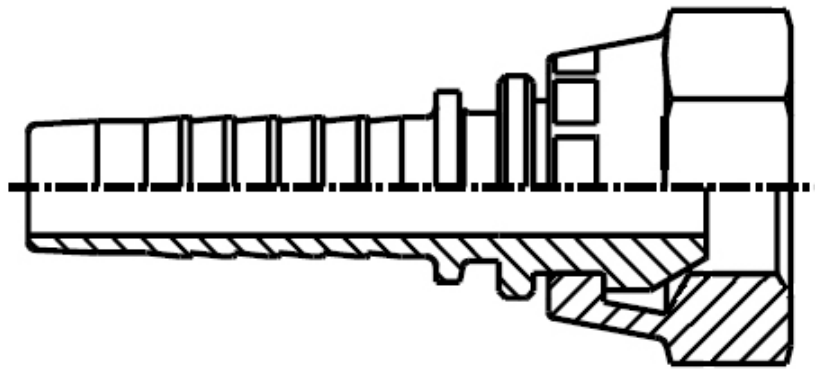

Artikelcode	Draadmaat	Ø Slang
C02NF04	1/8"	1/4"
C04NF04	1/4"	1/4"
C06NF06	3/8"	3/8"
C08NF08	1/2"	1/2"
C12NF12	3/4"	3/4"
C16NF16	1"	1"



**Koppeling met
buitendraad,
60° conus
NPT MALE**

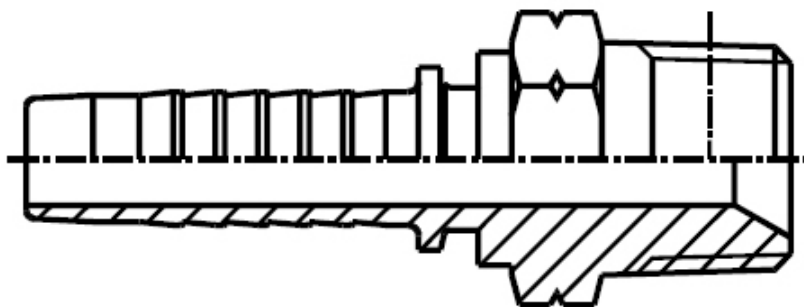

Artikelcode	Draadmaat	Ø Slang
C02NM03	1/8"	3/16"
C04NM03	1/4"	3/16"
C02NM04	1/8"	1/4"
C04NM04	1/4"	1/4"
C06NM04	3/8"	1/4"
C04NM05	1/4"	5/16"
C06NM05	3/4"	5/16"
C04NM06	1/4"	3/8"
C06NM06	3/8"	3/8"
C08NM06	1/2"	3/8"
C06NM08	3/8"	1/2"
C08NM08	1/2"	1/2"
C12NM08	3/4"	1/2"
C08NM10	1/2"	5/8"
C12NM10	3/4"	5/8"
C12NM12	3/4"	3/4"
C16NM12	1"	3/4"
C16NM16	1"	1"
C20NM20	1.1/4"	1.1/4"
C24NM24	1.1/2"	1.1/2"
C32NM32	2"	2"
C08NM08SW	1/2"	1/2" SWIVEL



Metrische pijpaansluiting voor snijringmontage

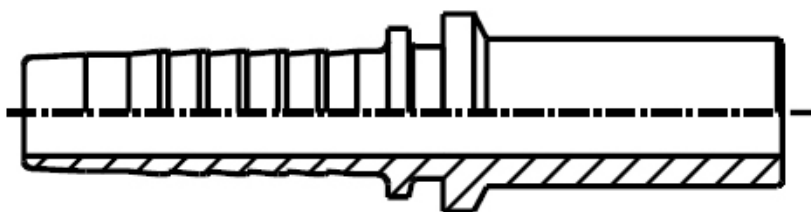

Artikelcode	Pijpmaat in mm	Ø Slang
C06P02	6	1/8"
C08P02	8	1/8"
C06P03	6	3/16"
C08P03	8	3/16"
C10P03	10	3/16"
C05P04	5	1/4"
C06P04	6	1/4"
C08P04	8	1/4"
C10P04	10	1/4"
C12P04	12	1/4"
C08P05	8	5/16"
C10P05	10	5/16"
C12P05	12	5/16"
C10P06	10	3/8"
C12P06	12	3/8"
C14P06	14	3/8"
C15P06	15	3/8"
C16P06	16	3/8"
C12P08	12	1/2"
C14P08	14	1/2"
C15P08	15	1/2"
C16P08	16	1/2"
C18P08	18	1/2"
C16P10	16	5/8"
C18P10	18	5/8"
C20P10	20	5/8"
C22P10	22	5/8"
C18P12	18	3/4"
C20P12	20	3/4"
C22P12	22	3/4"
C25P12	25	3/4"
C25P16	25	1"
C28P16	28	1"
C30P16	30	1"
C35P16	35	1"
C30P20	30	1.1/4"
C35P20	35	1.1/4"
C38P20	38	1.1/4"
C38P24	38	1.1/2"
C42P24	42	1.1/2"



45° Metrische pijpaansluiting voor snijringmontage

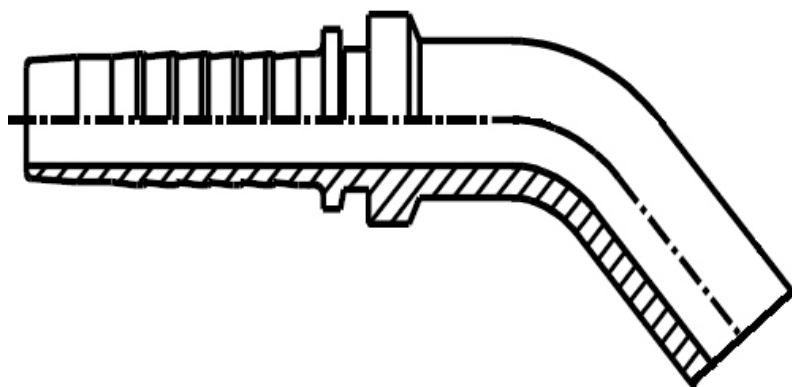

Artikelcode	Pijpmaat in mm	Ø Slang
C06P4503	6	3/16"
C08P4503	8	3/16"
C06P4504	6	1/4"
C08P4504	8	1/4"
C10P4504	10	1/4"
C12P4504	12	1/4"
C08P4505	8	5/16"
C10P4505	10	5/16"
C12P4505	12	5/16"
C08P4506	8	3/8"
C10P4506	10	3/8"
C12P4506	12	3/8"
C14P4506	14	3/8"
C15P4506	15	3/8"
C16P4506	16	3/8"
C14P4508	14	1/2"
C15P4508	15	1/2"
C16P4508	16	1/2"
C18P4508	18	1/2"
C16P4510	16	5/8"
C18P4510	18	5/8"
C20P4510	20	5/8"
C22P4510	22	5/8"
C18P4512	18	3/4"
C20P4512	20	3/4"
C22P4512	22	3/4"
C25P4512	25	3/4"
C25P4516	25	1"
C28P4516	28	1"
C30P4516	30	1"
C35P4520	35	1.1/4"
C38P4520	38	1.1/4"
C42P4524	42	1.1/2"



90° Metrische pijpaansluiting voor snijringmontage

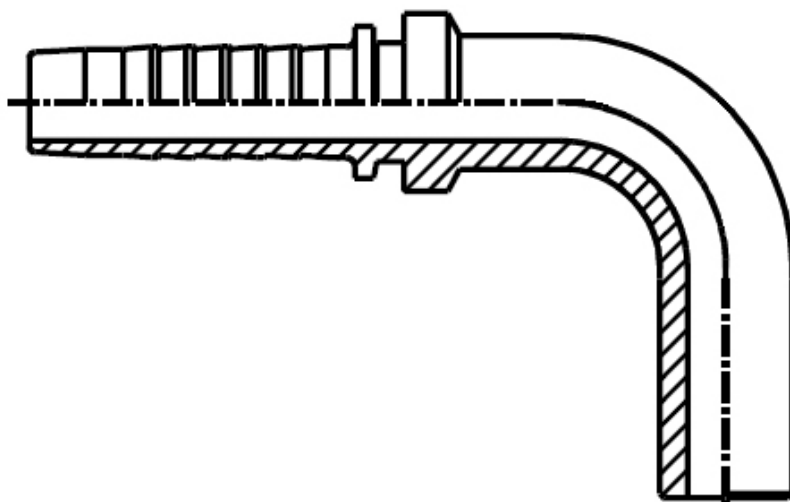

Artikelcode	Pijpmaat in mm	Ø Slang
C06P9003	6	3/16"
C08P9003	8	3/16"
C06P9004	6	1/4"
C08P9004	8	1/4"
C10P9004	10	1/4"
C12P9004	12	1/4"
C08P9005	8	5/16"
C10P9005	10	5/16"
C12P9005	12	5/16"
C08P9006	8	3/8"
C10P9006	10	3/8"
C12P9006	12	3/8"
C14P9006	14	3/8"
C15P9006	15	3/8"
C16P9006	16	3/8"
C12P9008	12	1/2"
C14P9008	14	1/2"
C15P9008	15	1/2"
C16P9008	16	1/2"
C18P9008	18	1/2"
C16P9010	16	5/8"
C18P9010	18	5/8"
C20P9010	20	5/8"
C22P9010	22	5/8"
C18P9012	18	3/4"
C20P9012	20	3/4"
C22P9012	22	3/4"
C25P9012	25	3/4"
C25P9016	25	1"
C28P9016	28	1"
C30P9016	30	1"
C35P9016	35	1"
C30P9020	30	1.1/4"
C35P9020	35	1.1/4"
C38P9020	38	1.1/4"
C38P9024	38	1.1/2"
C42P9024	42	1.1/2"



SAE flensaansluiting, 3000 PSI

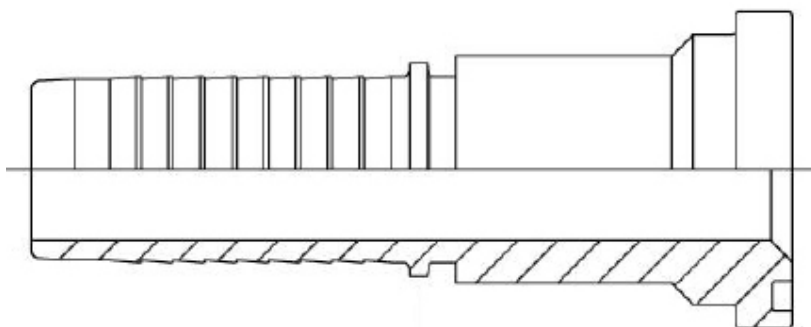

Artikelcode	Flensmaat	Ø Flens	Ø Slang
C08X308	1/2"	30.2	1/2"
C12X308	3/4"	38.1	1/2"
C08X310	1/2"	30.2	5/8"
C10X310	5/8"	34	5/8"
C12X310	3/4"	38.1	5/8"
C08X312	1/2"	30.2	3/4"
C12X312	3/4"	38.1	3/4"
C16X312	1"	44.5	3/4"
C12X316	3/4"	38.1	1"
C16X316	1"	44.5	1"
C20X316	1.1/4"	50.8	1"
C20X320	1.1/4"	50.8	1.1/4"
C24X320	1.1/2"	60.3	1.1/4"
C24X324	1.1/2"	60.3	1.1/2"
C32X324	2"	71.4	1.1/2"
C32X332	2"	71.4	2"
C40X332	2" 1/2	84.1	2"



SAE 45° flensaansluiting, 3000 PSI

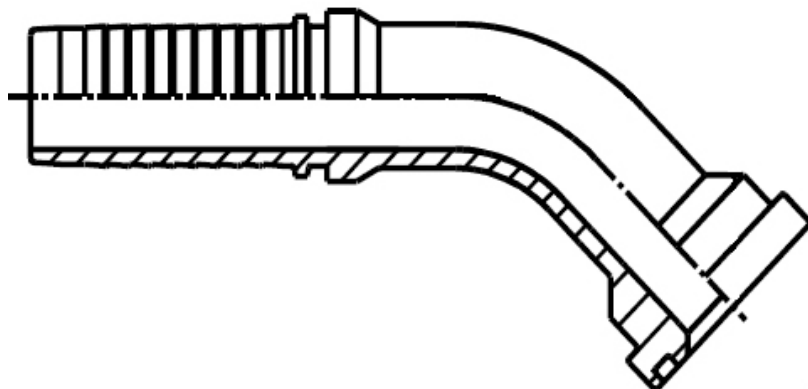

Artikelcode	Flensmaat	Ø Flens	Ø Slang
C08X34508	1/2"	30.2	1/2"
C10X34508	5/8"	34	1/2"
C12X34508	3/4"	38.1	1/2"
C08X34510	1/2"	30.2	5/8"
C10X34510	5/8"	34	5/8"
C12X34510	3/4"	38.1	5/8"
C08X34512	1/2"	30.2	3/4"
C12X34512	3/4"	38.1	3/4"
C16X34512	1"	44.5	3/4"
C12X34516	3/4"	38.1	1"
C16X34516	1"	44.5	1"
C20X34516	1.1/4"	50.8	1"
C20X34520	1.1/4"	50.8	1.1/4"
C24X34520	1.1/2"	60.3	1.1/4"
C24X34524	1.1/2"	60.3	1.1/2"
C32X34524	2"	71.4	1.1/2"
C32X34532	2"	71.4	2"
C40X34532	2.1/2"	84.1	2"



SAE 90° flensaansluiting, 3000 PSI

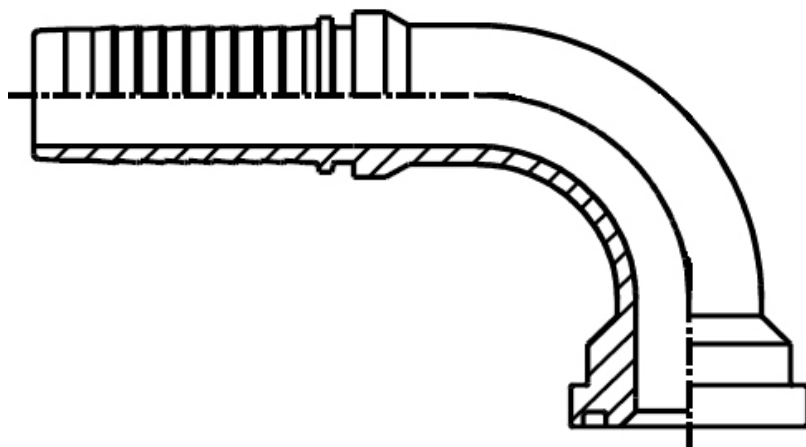

Artikelcode	Flensmaat	Ø Flens	Ø Slang
C08X39008	1/2"	30.2	1/2"
C10X39008	5/8"	34	1/2"
C12X39008	3/4"	38.1	1/2"
C08X39010	1/2"	30.2	5/8"
C10X39010	5/8"	34	5/8"
C12X39010	3/4"	38.1	5/8"
C08X39012	1/2"	30.2	3/4"
C12X39012	3/4"	38.1	3/4"
C16X39012	1"	44.5	3/4"
C20X39012	1" 1/4	50.8	3/4"
C12X39016	3/4"	38.1	1"
C16X39016	1"	44.5	1"
C20X39016	1.1/4"	50.8	1"
C16X39020	1"	44.5	1.1/4"
C20X39020	1.1/4"	50.8	1.1/4"
C24X39020	1.1/2"	60.3	1.1/4"
C24X39024	1.1/2"	60.3	1.1/2"
C32X39024	2"	71.4	1.1/2"
C32X39032	2"	71.4	2"
C40X39032	2.1/2"	84.1	2"



SAE flensaansluiting, 6000 PSI

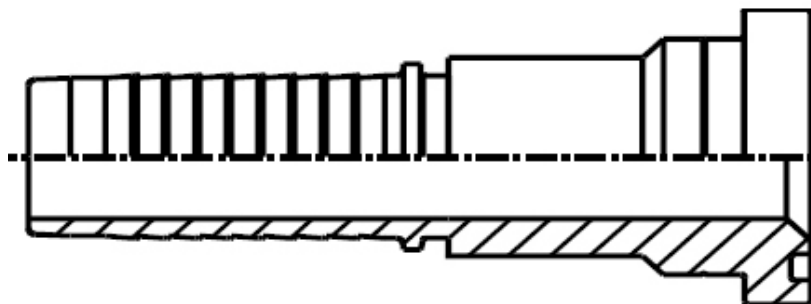

Artikelcode	Flensmaat	Ø Flens	Ø Slang
C08X608	1/2"	31.7	1/2"
C12X608	3/4"	41.3	1/2"
C08X610	1/2"	31.7	5/8"
C10X610	5/8"	34	5/8"
C12X610	3/4"	41.3	5/8"
C08X612	1/2"	31.7	3/4"
C12X612	3/4"	41.3	3/4"
C16X612	1"	47.6	3/4"
C12X616	3/4"	41.3	1"
C16X616	1"	47.6	1"
C20X616	1.1/4"	54	1"
C16X620	1"	47.6	1.1/4"
C20X620	1.1/4"	54	1.1/4"
C24X620	1.1/2"	63.5	1.1/4"
C24X624	1.1/2"	63.5	1.1/2"
C32X624	2"	79.4	1.1/2"
C32X632	2"	79.4	2"



SAE 45° flensaansluiting, 6000 PSI

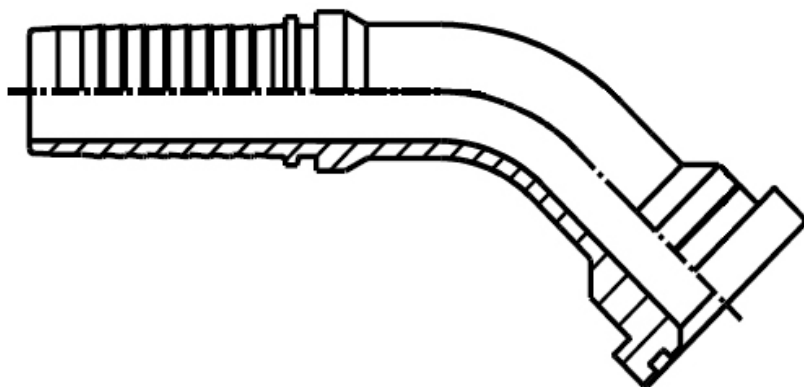

Artikelcode	Flensmaat	Ø Flens	Ø Slang
C08X64508	1/2"	31.7	1/2"
C12X64508	3/4"	41.3	1/2"
C08X64510	1/2"	31.7	5/8"
C12X64510	3/4"	41.3	5/8"
C08X64512	1/2"	31.7	3/4"
C12X64512	3/4"	41.3	3/4"
C16X64512	1"	47.6	3/4"
C12X64516	3/4"	41.3	1"
C16X64516	1"	47.6	1"
C20X64516	1.1/4"	54	1"
C16X64520	1"	47.6	1.1/4"
C20X64520	1.1/4"	54	1.1/4"
C24X64520	1.1/2"	63.5	1.1/4"
C24X64524	1.1/2"	63.5	1.1/2"
C32X64524	2"	79.4	1.1/2"
C32X64532	2"	79.4	2"



SAE 90° flensaansluiting, 6000 PSI

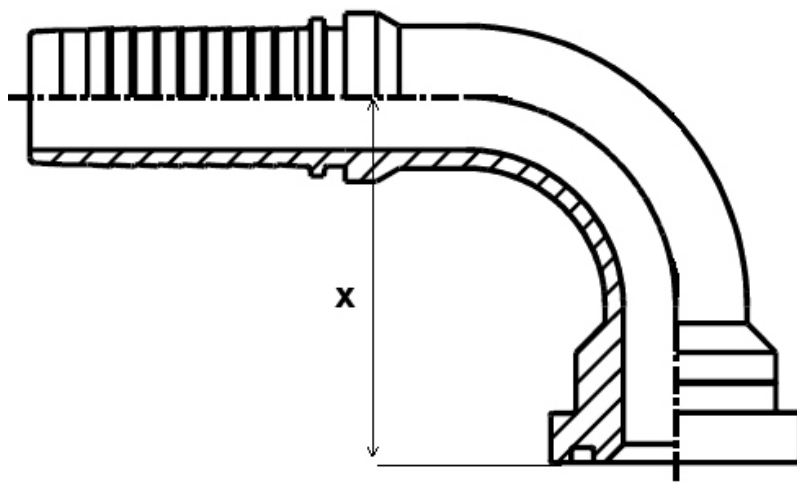

Artikelcode	Flensmaat	Ø Flens	Ø Slang	Bochthoogte X in mm
C08X69008	1/2"	31.7	1/2"	
C12X69008	3/4"	41.3	1/2"	
C08X69010	1/2"	31.7	5/8"	
C12X69010	3/4"	41.3	5/8"	
C08X69012	1/2"	31.7	3/4"	
C12X69012	3/4"	41.3	3/4"	
C16X69012	1"	47.6	3/4"	
C20X69012	1.1/4"	54	3/4"	
C12X69016	3/4"	41.3	1"	
C16X69016	1"	47.6	1"	
C20X69016	1.1/4"	54	1"	
C16X69020	1"	47.6	1.1/4"	
C20X69020	1.1/4"	54	1.1/4"	
C24X69020	1.1/2"	63.5	1.1/4"	
C24X69024	1.1/2"	63.5	1.1/2"	
C32X69024	2"	79.4	1.1/2"	
C32X69032	2"	79.4	2"	
C12X6900885	3/4"	41.3	1/2"	85
C12X6901085	3/4"	41.3	5/8"	85
C16X6901085	1"	47.6	5/8"	85
C08X6901280	1/2"	31.7	3/4"	80
C08X69012100	1/2"	31.7	3/4"	100
C12X6901275	3/4"	41.3	3/4"	75
C12X6901285	3/4"	41.3	3/4"	85
C12X6901295	3/4"	41.3	3/4"	95
C12X69012110	3/4"	41.3	3/4"	110
C12X69012150	3/4"	41.3	3/4"	150
C16X6901290	1"	47.6	3/4"	90
C16X69012120	1"	47.6	3/4"	120
C12X6901685	3/4"	41.3	1"	85
C12X69016110	3/4"	41.3	1"	110
C12X69016120	3/4"	41.3	1"	120
C12X69016150	3/4"	41.3	1"	150
C16X6901655	1"	47.6	1"	55
C16X6901685	1"	47.6	1"	85
C16X69016100	1"	47.6	1"	100
C16X69016120	1"	47.6	1"	120
C16X69016130	1"	47.6	1"	130



Artikelcode	Flensmaat	Ø Flens	Ø Slang	Bochthoogte X in mm
C16X69016140	1"	47.6	1"	140
C16X69016150	1"	47.6	1"	150
C20X69016100	1.1/4"	54	1"	100
C20X69016180	1.1/4"	54	1"	180



Wartelkoppeling met 60° conus BSP FEMALE INTERLOCK

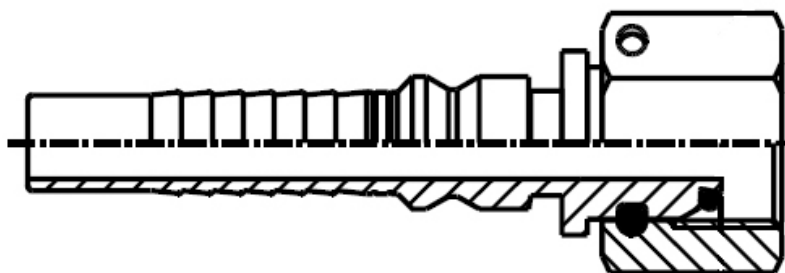

Artikelcode	Draadmaat	Ø Slang
H08BF08	1/2"	1/2"
H12BF12	3/4"	3/4"
H16BF16	1"	1"
H20BF20	1.1/4"	1.1/4"
H24BF24	1.1/2"	1.1/2"
H32BF32	2"	2"



45° Wartelkoppeling met 60° conus BSP FEMALE INTERLOCK

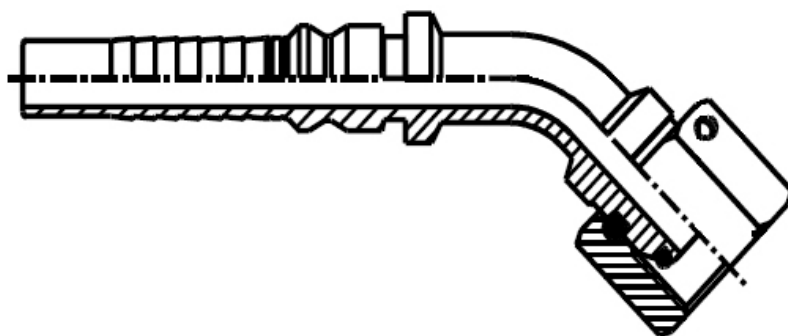

Artikelcode	Draadmaat	Ø Slang
H12B4512	3/4"	3/4"
H16B4516	1"	1"
H20B4520	1.1/4"	1.1/4"
H24B4524	1.1/2"	1.1/2"
H32B4532	2"	2"



90° Wartelkoppeling met 60° conus BSP FEMALE INTERLOCK

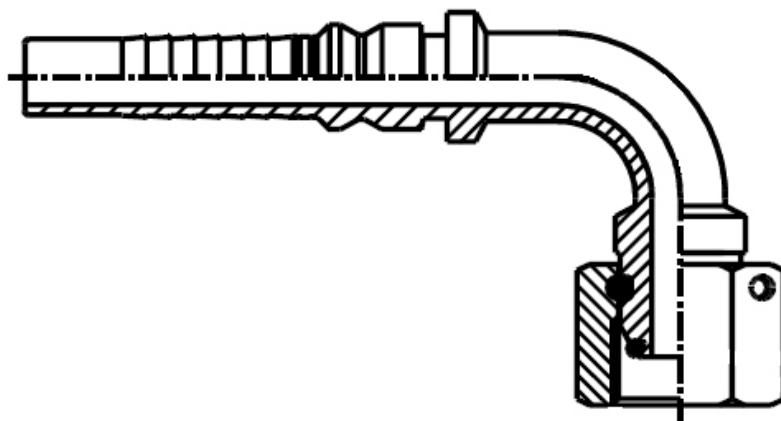

Artikelcode	Draadmaat	Ø Slang
H12B9012	3/4"	3/4"
H16B9016	1"	1"
H20B9020	1.1/4"	1.1/4"
H24B9024	1.1/2"	1.1/2"
H32B9032	2"	2"



**Koppeling,
buitendraad met 60°
conus**
BSP MALE INTERLOCK

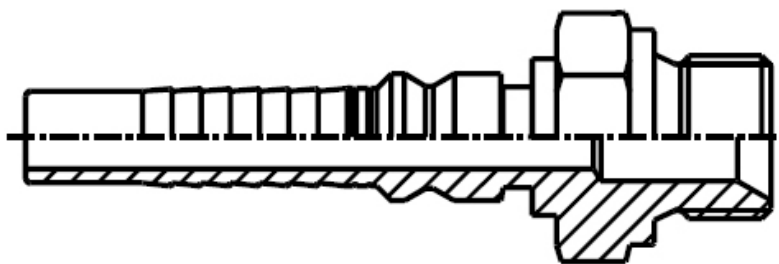

Artikelcode	Draadmaat	Ø Slang
H06BM06	3/8"	3/8"
H08BM08	1/2"	1/2"
H10BM10	5/8"	5/8"
H12BM12	3/4"	3/4"
H16BM16	1"	1"
H20BM20	1.1/4"	1.1/4"
H24BM24	1.1/2"	1.1/2"
H32BM32	2"	2"



Wartelkoppeling met 24° conus

METRISCH FEMALE INTERLOCK

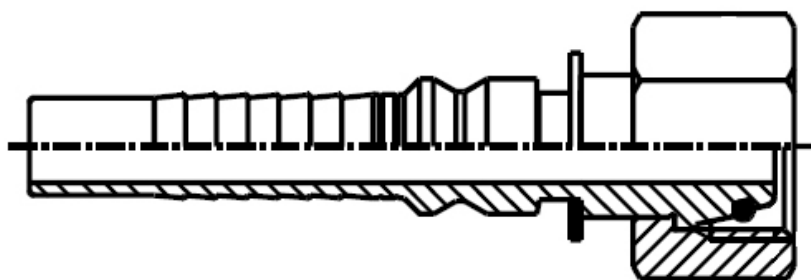

Artikelcode	Draadmaat	Pijpmaat	Ø Slang
H22DF14S06	M22x1.5	14	3/8"
H24DF16S08	M24x1.5	16	1/2"
H30DF20S12	M30x2	20	3/4"
H36DF25S12	M36x2	25	3/4"
H36DF25S16	M36x2	25	1"
H42DF30S16	M42x2	30	1"
H52DF38S20	M52x2	38	1.1/4"
H36DF25S12SW41	M36x2 SLEUTEL- WIJDTE 41	25	3/4"



45° Wartelkoppeling met 24° conus en o-ring

METRISCH FEMALE INTERLOCK
DIN 3865

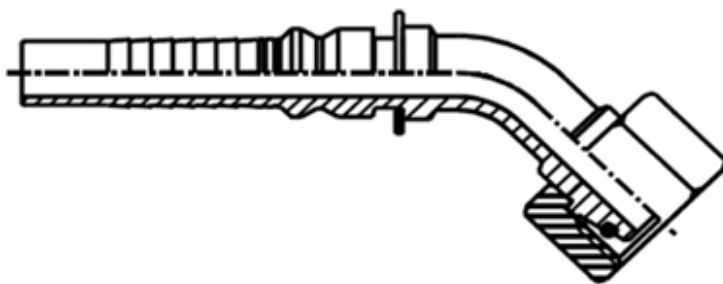

Artikelcode	Draadmaat	Pijpmaat in mm	Ø Slang
H30D4520S10	M30x2	20	5/8"
H30D4520S12	M30x2	20	3/4"
H36D4525S12	M36x2	25	3/4"
H36D4525S16	M36x2	25	1"
H42D4530S16	M42x2	30	1"
H52D4538S20	M52x2	38	1.1/4"
H36D4525S12SW41	M36x2 SLEUTEL- WIJDTE 41	25	3/4"



**90° Wartelkoppeling
met 24° conus en
o-ring**
METRISCH FEMALE INTERLOCK
DIN 3865

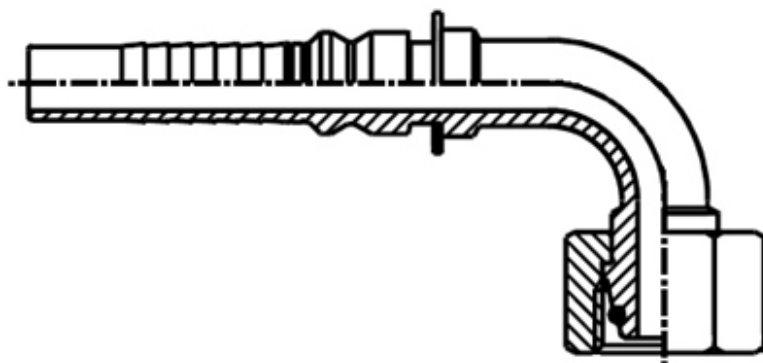

Artikelcode	Draadmaat	Pijpmaat in mm	Ø Slang
H22D9014S06	M22x1.5	14	3/8"
H24D9016S08	M24x1.5	16	1/2"
H30D9020S10	M30x2	20	5/8"
H30D9020S12	M30x2	20	3/4"
H36D9025S12	M36x2	25	3/4"
H36D9025S16	M36x2	25	1"
H42D9030S16	M42x2	30	1"
H52D9038S20	M52x2	38	1.1/4"
H36D9025S12SW41	M36x2 SLEUTEL- WIJDTE 41	25	3/4"



**Koppeling met
buitendraad voor
snijringmontage,
met 24° conus**
METRISCH MALE INTERLOCK
DIN 3853

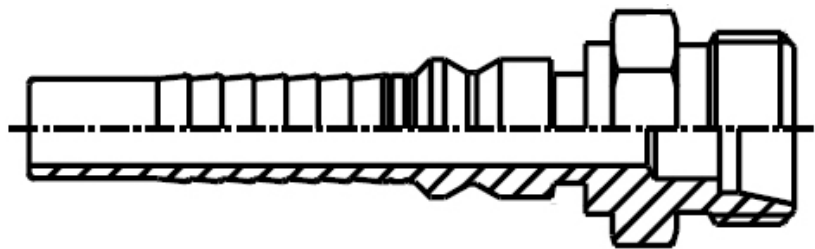

Artikelcode	Draadmaat	Pijpmaat in mm	Ø Slang
H22ME14S06	M22x1.5	14	3/8"
H24ME16S08	M24x1.5	16	1/2"
H30ME20S10	M30x2	20	5/8"
H30ME20S12	M30x2	20	3/4"
H36ME25S12	M36x2	25	3/4"
H42ME30S16	M42x2	30	1"
H52ME38S20	M52x2	38	1.1/4"



JIC Wartelkoppeling met 74° conus UNF FEMALE INTERLOCK

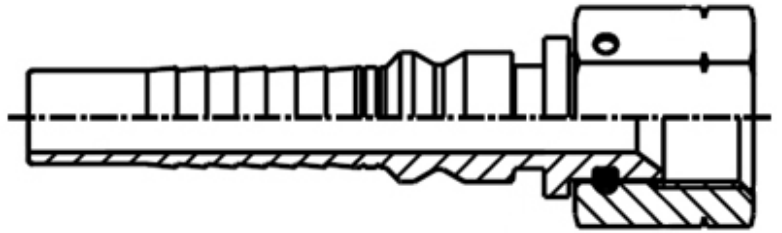

Artikelcode	Draadmaat	Ø Slang
H17JF12	1.1/16"	3/4"
H21JF12	1.5/16"	3/4"
H21JF16	1.5/16"	1"
H26JF16	1.5/8"	1"
H26JF20	1.5/8"	1.1/4"
H30JF20	1.7/8"	1.1/4"
H30JF24	1.7/8"	1.1/2"
H40JF32	2.1/2"	2"



45° JIC
Wartelkoppeling
met 74° conus
UNF FEMALE INTERLOCK

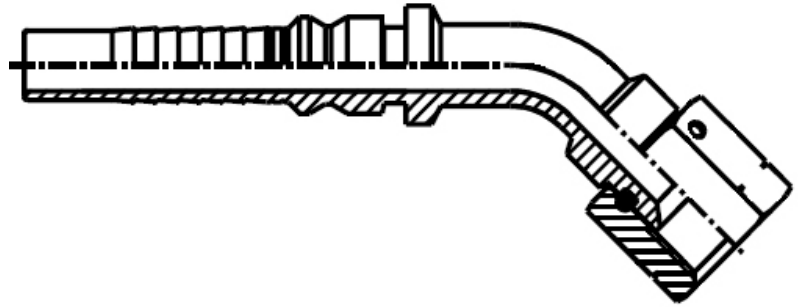

Artikelcode	Draadmaat	Ø Slang
H17J4512	1.1/16"	3/4"
H21J4512	1.5/16"	3/4"
H21J4516	1.5/16"	1"
H26J4520	1.5/8"	1.1/4"
H30J4524	1.7/8"	1.1/2"
H40J4532	2.1/2"	2"



90° JIC
Wartelkoppeling
met 74° conus
UNF FEMALE INTERLOCK

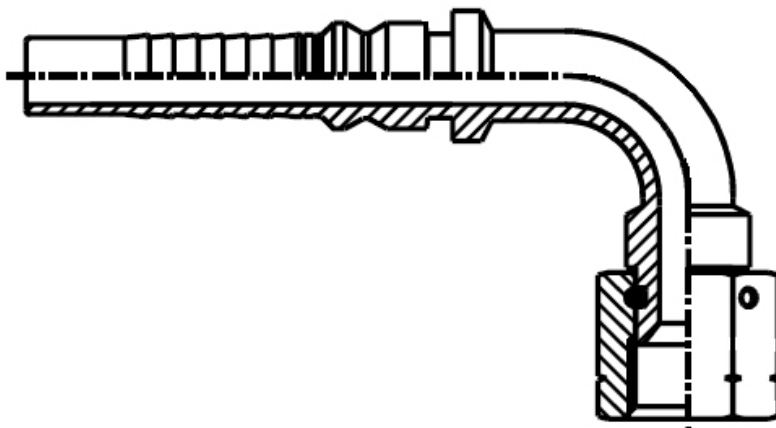

Artikelcode	Draadmaat	Ø Slang
H17J9012	1.1/16"	3/4"
H21J9012	1.5/16"	3/4"
H21J9016	1.5/16"	1"
H42J9016	2.5/8"	1"
H26J9020	1.5/8"	1.1/4"
H30J9020	1.7/8"	1.1/4"
H30J9024	1.7/8"	1.1/2"
H40J9032	2.1/2"	2"



**JIC Koppeling,
buitendraad met 74°
conus
UNF MALE INTERLOCK**



Artikelcode	Draadmaat	Ø Slang
H09JM06	9/16"	3/8"
H12JM08	3/4"	1/2"
H14JM10	7/8"	5/8"
H17JM12	1.1/16"	3/4"
H21JM12	1.5/16"	3/4"
H21JM16	1.5/16"	1"
H26JM16	1.5/8"	1"
H26JM20	1.5/8"	1.1/4"
H30JM20	1.7/8"	1.1/4"
H30JM24	1.7/8"	1.1/2"
H40JM32	2.1/2"	2"



**Koppeling met
buitendraad,
60° conus
NPT MALE INTERLOCK**

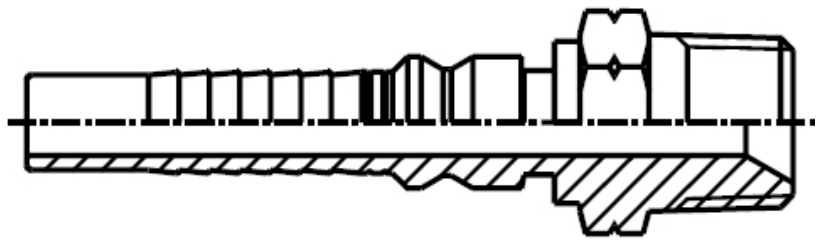

Artikelcode	Draadmaat	Ø Slang
H06NM06	3/8"	3/8"
H08NM08	1/2"	1/2"
H12NM12	3/4"	3/4"
H16NM16	1"	1"
H20NM20	1.1/4"	1.1/4"
H24NM24	1.1/2"	1.1/2"
H32NM32	2"	2"



ORFS
Wartelkoppeling,
vlakdichtend
UNF FEMALE INTERLOCK

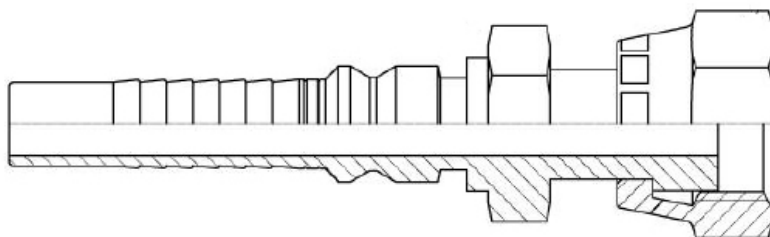

Artikelcode	Draadmaat	Ø Slang
H19LORF10	1.3/16"	5/8"
H19LORF12	1.3/16"	3/4"
H23LORF12	1.7/16"	3/4"
H23LORF16	1.7/16"	1"
H27LORF16	1.11/16"	1"
H27LORF20	1.11/16"	1.1/4"



45° ORFS
Wartelkoppeling,
vlakdichtend
UNF FEMALE INTERLOCK

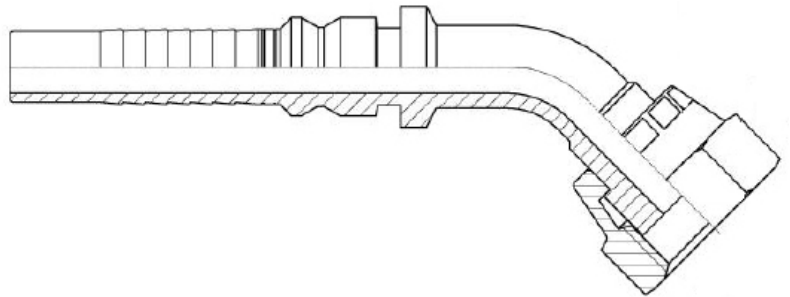

Artikelcode	Draadmaat	Ø Slang
H19LORF4510	1.3/16"	5/8"
H19LORF4512	1.3/16"	3/4"
H23LORF4512	1.7/16"	3/4"
H23LORF4516	1.7/16"	1"
H27LORF4516	1.11/16"	1"
H27LORF4520	1.11/16"	1.1/4"



90° ORFS
Wartelkoppeling,
vlakdichtend
UNF FEMALE INTERLOCK

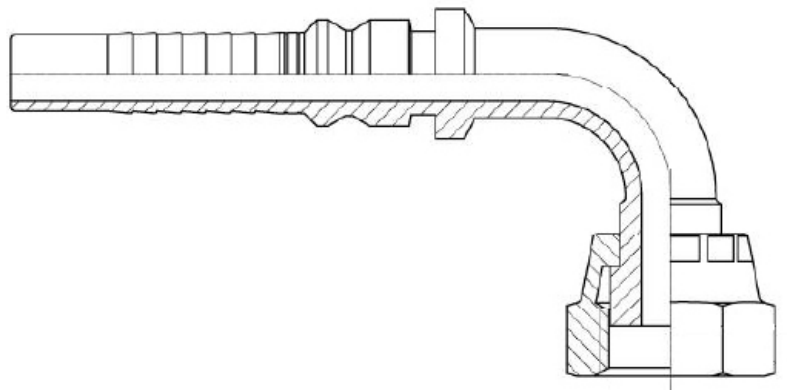

Artikelcode	Draadmaat	Ø Slang
H19LORF9010	1.3/16"	5/8"
H19LORF9012	1.3/16"	3/4"
H23LORF9012	1.7/16"	3/4"
H23LORF9016	1.7/16"	1"
H27LORF9016	1.11/16"	1"
H27LORF9020	1.11/16"	1.1/4"



**SAE
flensaansluiting,
3000 PSI
INTERLOCK**



Artikelcode	Flensmaat	Ø Flens	Ø Slang
H12X310	3/4"	38.1	5/8"
H12X312	3/4"	38.1	3/4"
H16X312	1"	44.5	3/4"
H16X316	1"	44.5	1"
H20X316	1.1/4"	50.8	1"
H20X320	1.1/4"	50.8	1.1/4"
H24X320	1.1/2"	60.3	1.1/4"
H24X324	1.1/2"	60.3	1.1/2"
H32X324	2"	71.4	1.1/2"
H32X332	2"	71.4	2"



**SAE 45°
flensaansluiting,
3000 PSI
INTERLOCK**

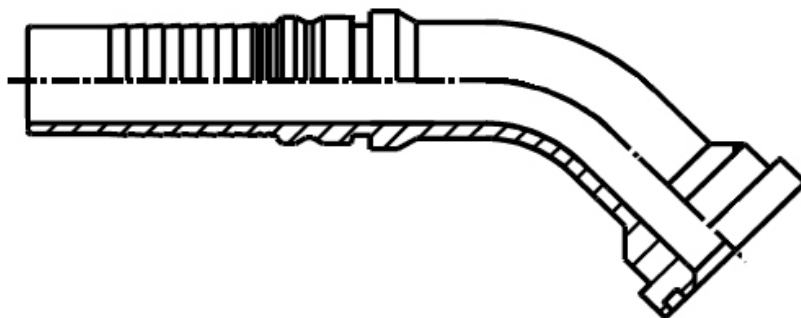

Artikelcode	Flensmaat	Ø Flens	Ø Slang
H12X34512	38.1	3/4"	3/4"
H16X34512	44.5	1"	3/4"
H16X34516	44.5	1"	1"
H20X34516	50.8	1.1/4"	1"
H20X34520	50.8	1.1/4"	1.1/4"
H24X34520	60.3	1.1/2"	1.1/4"
H24X34524	60.3	1.1/2"	1.1/2"
H32X34524	71.4	2"	1.1/2"
H32X34532	71.4	2"	2"



**SAE 90°
flensaansluiting,
3000 PSI
INTERLOCK**

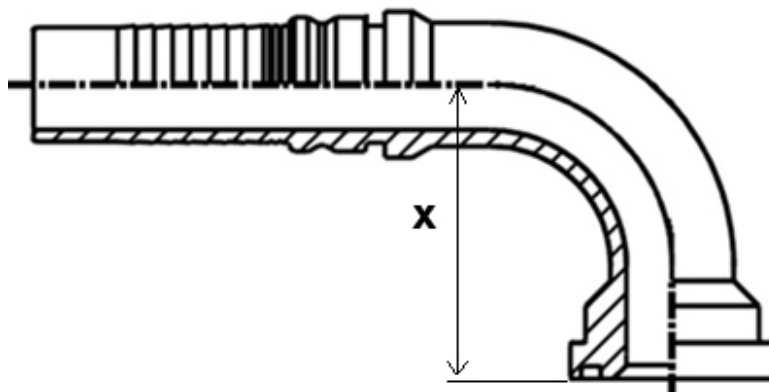

Artikelcode	Flensmaat	Ø Flens	Ø Slang	Bochthoogte X in mm
H12X39010	3/4"	38.1	5/8"	
H12X39012	3/4"	38.1	3/4"	
H12X39012110	3/4"	38.1	3/4"	110
H16X39012	1"	44.5	3/4"	
H16X39016	1"	44.5	1"	
H20X39016	1.1/4"	50.8	1"	
H20X39020	1.1/4"	50.8	1.1/4"	
H24X39020	1.1/2"	60.3	1.1/4"	
H32X39024	2"	71.4	1.1/2"	
H24X39024	1.1/2"	60.3	1.1/2"	
H32X39032	2"	71.4	2"	



**SAE
flensaansluiting,
6000 PSI
INTERLOCK**

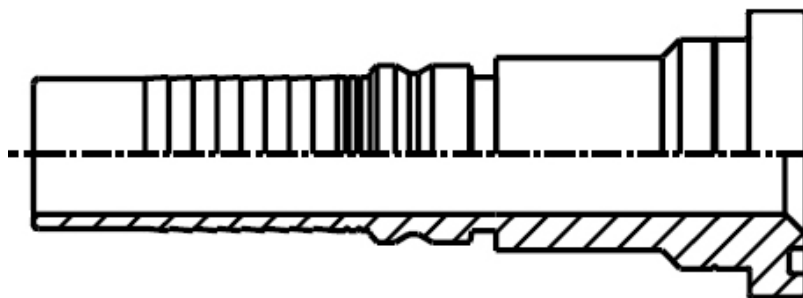

Artikelcode	Flensmaat	Ø Flens	Ø Slang
H08X6	31.8	1/2"	1/2"
H12X6	41.3	3/4"	5/8"
H12X6	41.3	3/4"	3/4"
H16X6	47.6	1"	3/4"
H12X6	41.3	3/4"	1"
H16X6	47.6	1"	1"
H20X6	54	1.1/4"	1"
H20X6	54	1.1/4"	1.1/4"
H24X6	63.5	1.1/2"	1.1/4"
H20X6	54	1.1/4"	1.1/2"
H24X6	63.5	1.1/2"	1.1/2"
H32X6	79.4	2"	1.1/2"
H32X6	79.4	2"	2"



**SAE 45°
flensaansluiting,
6000 PSI
INTERLOCK**

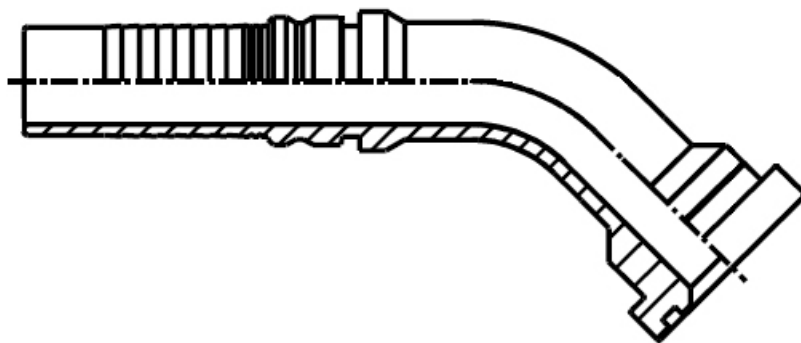

Artikelcode	Flensmaat	Ø Flens	Ø Slang
H08X64508	31.8	1/2"	1/2"
H12X64510	41.3	3/4"	5/8"
H12X64512	41.3	3/4"	3/4"
H16X64512	47.6	1"	3/4"
H16X64516	47.6	1"	1"
H20X64516	54	1.1/4"	1"
H20X64520	54	1.1/4"	1.1/4"
H24X64520	63.5	1.1/2"	1.1/4"
H24X64524	63.5	1.1/2"	1.1/2"
H32X64524	79.4	2"	1.1/2"
H32X64532	79.4	2"	2"



**SAE 90°
flensaansluiting,
6000 PSI
INTERLOCK**

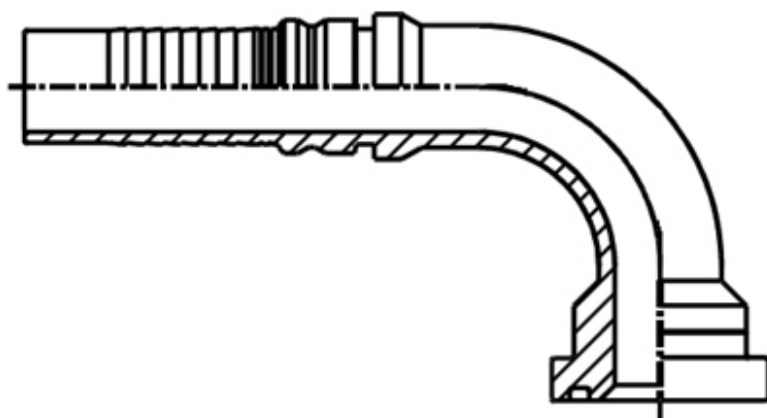

Artikelcode	Flensmaat	Ø Flens	Ø Slang
H08X69008	31.8	1/2"	1/2"
H12X69010	41.3	3/4"	5/8"
H12X69012	41.3	3/4"	3/4"
H16X69012	47.6	1"	3/4"
H16X69016	47.6	1"	1"
H20X69016	54	1.1/4"	1"
H20X69020	54	1.1/4"	1.1/4"
H24X69020	63.5	1.1/2"	1.1/4"
H24X69024	63.5	1.1/2"	1.1/2"
H32X69024	79.4	2"	1.1/2"
H32X69032	79.4	2"	2"



SAE
flensaansluiting,
9000 PSI
INTERLOCK CATERPILLAR

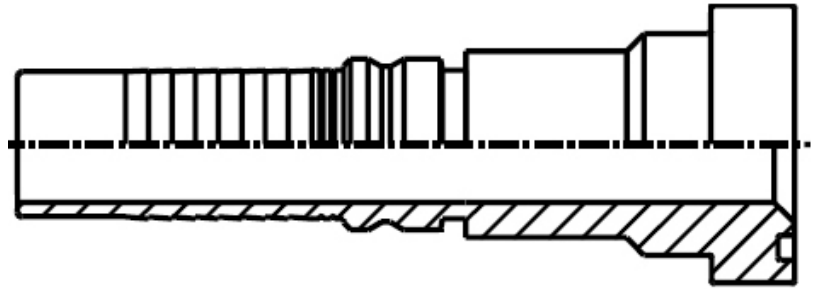

Artikelcode	Flensmaat	Ø Flens	Ø Slang
H12X912	3/4"	41.3	3/4"
H16X916	1"	47.6	1"
H20X920	1" 1/4	54	1.1/4"



**SAE 45°
flensaansluiting,
9000 PSI
INTERLOCK CATERPILLAR**

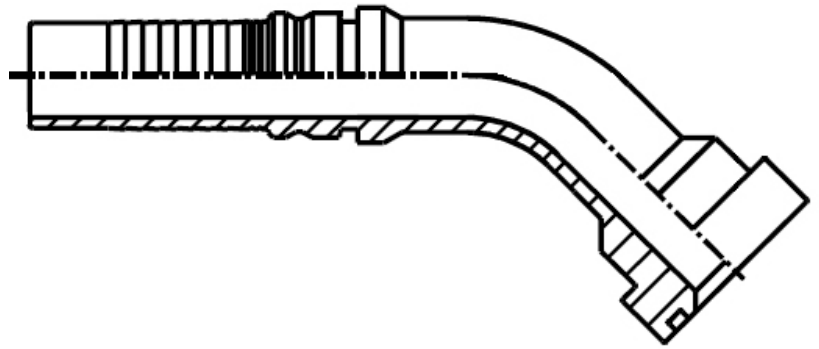

Artikelcode	Flensmaat	Ø Flens	Ø Slang
H12X94512	3/4"	41.3	3/4"
H16X94516	1"	47.6	1"



**SAE 90°
flensaansluiting,
9000 PSI
INTERLOCK CATERPILLAR**

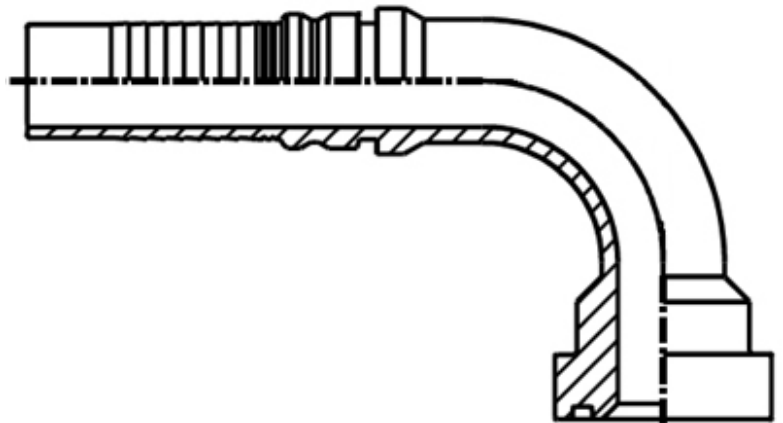

Artikelcode	Flensmaat	Ø Flens	Ø Slang
H12X99012	3/4"	41.3	3/4"
H16X99016	1"	47.6	1"

